



**Appearance & Shape:** To be free from any defect such as flow, burrs, unevenness etc; as per IEC standards

**Effective parameters irrespective of material grade (per set)**

Parameter	Value	Unit
Effective Length ( $L_e$ )	92	mm
Effective Area ( $A_e$ )	125	mm <sup>2</sup>
Effective Area ( $A_{Min}$ )	123	mm <sup>2</sup>
Effective Volume ( $V_e$ )	11500	mm <sup>3</sup>
Approx. Weight (without gap)	57	g/set



**ETD3913 Un-gapped (OL)**

**Test Conditions: 1kHz/1mT/CFR COIL,N=100/25°C**

Material Grade	Initial Permeability ( $\mu_{iac}$ )	AL Value (nH)/Set	$P_v$ (W/set)	Ordering code
CF292	1800 ±20%	2550 +30%/-20%	≤1.40 (100mT,100kHz,100°C)	CF292 ETD3913 OL
CF139	2100 ±20%	2950 +30%/-20%	≤1.15 (100mT,100kHz,100°C)	CF139 ETD3913 OL
CF297	2300 ±20%	3200 +30%/-20%	≤1.03 (100mT,100kHz,100°C)	CF297 ETD3913 OL
CF124	2500 ±20%	3450 +30%/-20%	≤1.72 (200mT,25kHz,100°C)	CF124 ETD3913 OL

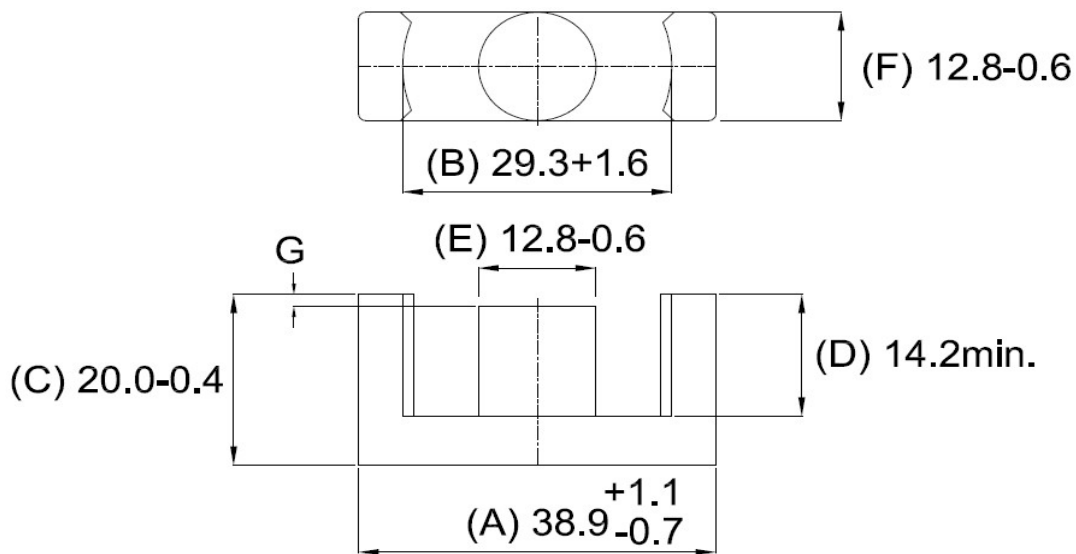

Remarks: Value of "G" is Zero (0) for Un-Gapped Cores, for Gapped Cores the value of "G" varies as per the Gap/AL value

