

**Appearance & Shape:** To be free from any defect such as flow, burrs, unevenness etc; as per IEC standards**Effective parameters irrespective of material grade (per set)**

| Parameter | Value | Unit |
|------------------------------|-------|-----------------|
| Effective Length (L_e) | 71.0 | mm |
| Effective Area (A_e) | 76.0 | mm ² |
| Effective Area (A_{Min}) | 71.0 | mm ² |
| Effective Volume (V_e) | 5377 | mm ³ |
| Approx. Weight (without gap) | 27 | g/set |

**ETD2910 Un-gapped (OL)****Test Conditions: 1kHz/1mT/CFR COIL,N=100/25°C**

| Material Grade | Initial Permeability (μ_{iac}) | AL Value (nH)/Set | P_v (W/set) | Ordering code |
|----------------|--------------------------------------|-------------------|----------------------------|------------------|
| CF292 | 1800 ±20% | 2100 +30%/-20% | ≤0.64 (100mT,100kHz,100°C) | CF292 ETD2910 OL |
| CF139 | 2100 ±20% | 2350 +30%/-20% | ≤0.53 (100mT,100kHz,100°C) | CF139 ETD2910 OL |
| CF297 | 2300 ±20% | 2500 +30%/-20% | ≤0.48 (100mT,100kHz,100°C) | CF297 ETD2910 OL |
| CF124 | 2500 ±20% | 2650 +30%/-20% | ≤0.80 (200mT,25kHz,100°C) | CF124 ETD2910 OL |

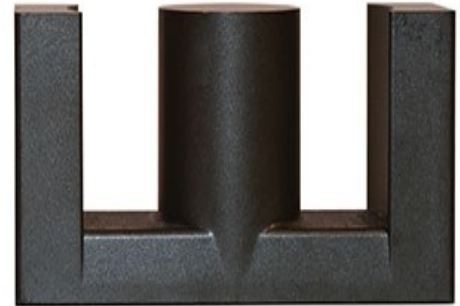
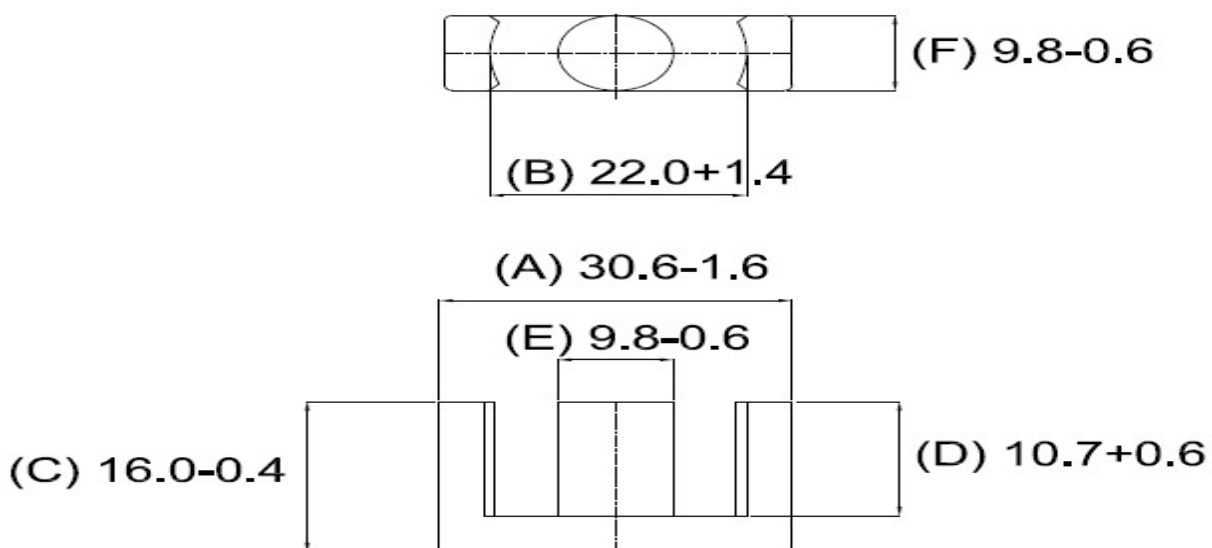

Remarks: Value of "G" is Zero (0) for Un-Gapped Cores, for Gapped Cores the value of "G" varies as per the Gap/AL value