

**Appearance & Shape:** To be free from any defect such as flow, burrs, unevenness etc, As per IEC standards.

**Effective Parameters irrespective of material grade (per set)**

- Effective Length ( $L_e$ ): 98.3mm
- Effective Area ( $A_e$ ): 233mm<sup>2</sup>
- Effective Area ( $A_{Min}$ ): 231mm<sup>2</sup>
- Effective Volume ( $V_e$ ): 22904mm<sup>3</sup>

**Approximate weight (without Gap): 114g/Set**



## EER4320 Un-gapped (OL)

**Test Conditions: 1kHz/1mT/N=100/25°C**

Material	Initial Permeability ( $\mu_{iac}$ )	AL Value (nH)	$P_v$ (W/set)
CF139	2100 ±20%	5300 +30%/-20%	<2.29(100mT,100kHz, 100°C)

## Dimensions :

Dimension	Nominal (in mm)	Maximum (in mm)	Minimum (in mm)
A	42.8	43.4	42.2
B	32.8	33.3	32.3
C	21.4	21.6	21.2
D	15.5	15.7	15.3
E	17.3	17.55	17.05
F	19.6	19.9	19.3

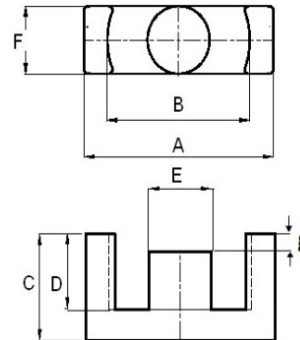

For Cosmo Ferrites Limited-INDIA

Checked By: A.K.  
 Approved By: B.S.  
 Authorized By: KSR  
 Date: 11-11-2019(ISSUE No. - 1)

Customer's Approval  
 Authorized Signatory:  
 Name:  
 Date: