

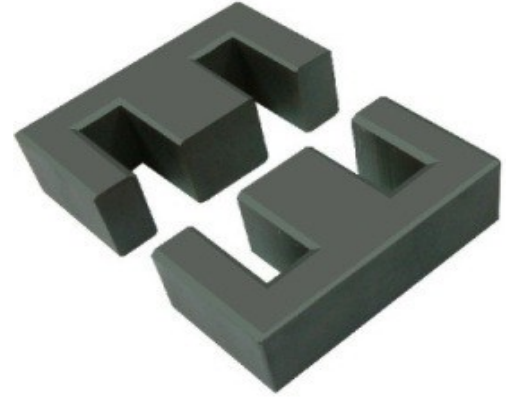

Appearance & Shape: To be free from any defect such as flow, burrs, unevenness etc; as per IEC standards

Effective parameters irrespective of material grade (per set)

Parameter	Value	Unit
Effective Length (L_e)	147	mm
Effective Area (A_e)	532	mm ²
Effective Area (A_{Min})	529	mm ²
Effective Volume (V_e)	78200	mm ³
Approx. Weight (without gap)	385	g/set



EE6527 Un-gapped (OL)

Test Conditions: 1kHz/1mT/CFR COIL,N=100/25°C

Material Grade	Initial Permeability (μ_{iac})	AL Value (nH)/Set	P_v (W/set)
CF292	1800 ±20%	6900 +30%/-20%	≤9.4(100mT,100kHz,100°C)
CF139	2100 ±20%	8100 +30%/-20%	≤7.8(100mT,100kHz,100°C)
CF297	2300 ±20%	8300 +30%/-20%	≤7.0(100mT,100kHz,100°C)
CF124	2500 ±20%	8500 +30%/-20%	≤11.7 (200mT,25kHz,100°C)

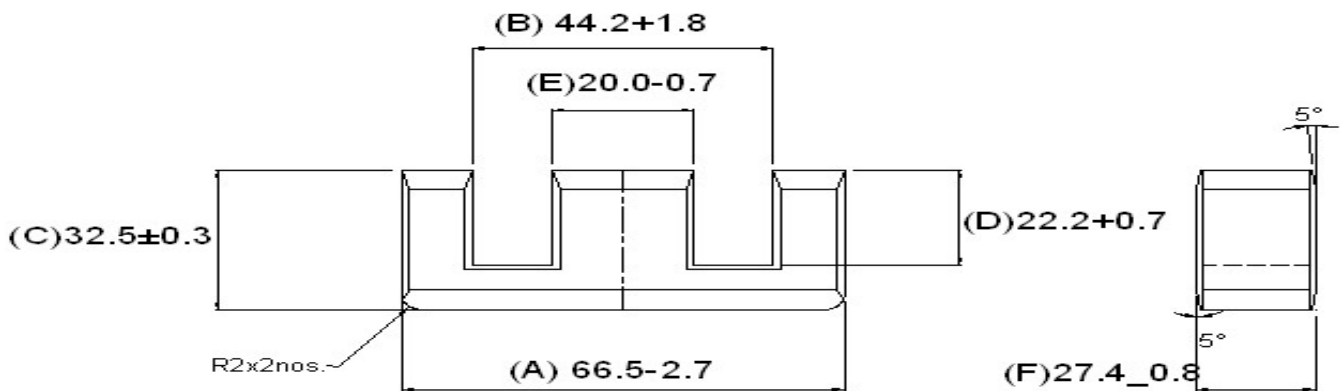

- Note :**
- 5° taper on top & bottom as shown in Figure.
 - R 2 on corners.

Remarks: Value of “G” is Zero (0) for Un-Gapped Cores, for Gapped Cores the value of “G” varies as per the Gap/AL value

