

# EE150

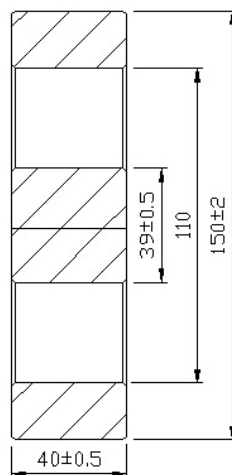

| Parameter             | Symbol | Value  | Unit              |
|-----------------------|--------|--------|-------------------|
| Core constant         | C1     | 0.3    | mm <sup>-1</sup>  |
| Effective path length | Le     | 490    | mm                |
| Effective area        | Ae     | 1560   | mm <sup>2</sup>   |
| Effective volume      | Ve     | 808800 | mm <sup>3</sup>   |
| Inductance factor     | AL     | 8300   | nH/N <sup>2</sup> |
| Weight of set         | W      | 3916   | g                 |
|                       |        |        |                   |
|                       |        |        |                   |

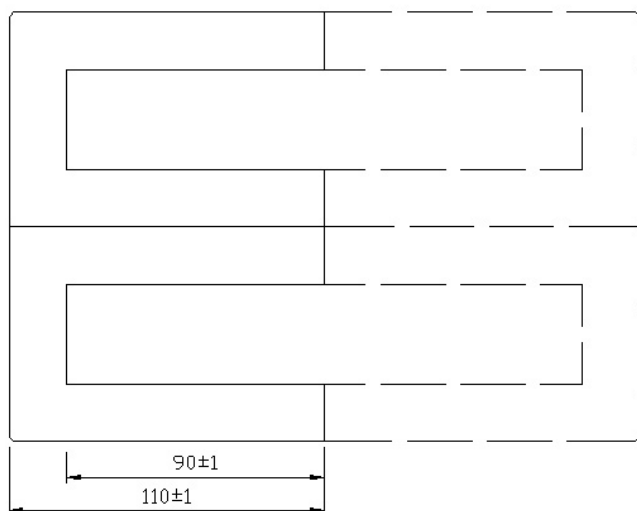
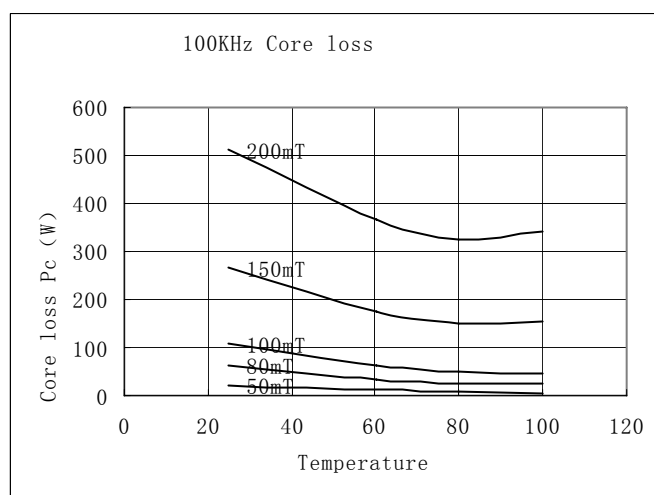
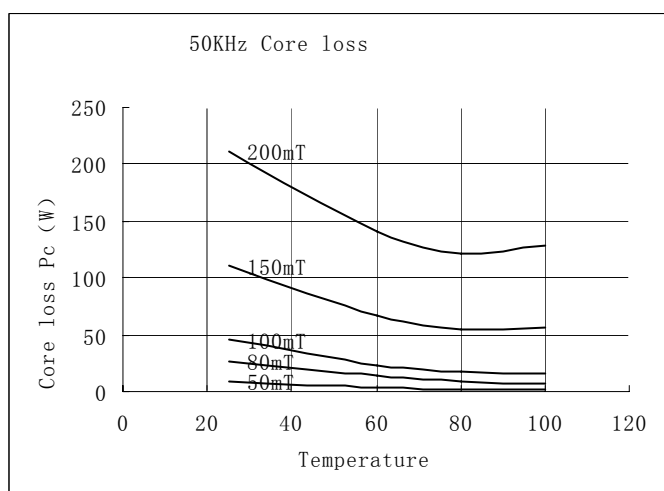

| Circuit Type        | Calculated Output Power |        |        |        | Unit:W |
|---------------------|-------------------------|--------|--------|--------|--------|
|                     | Switching Frequency     |        |        |        |        |
|                     | 20KHz                   | 50KHz  | 100KHz | 250KHz |        |
| Push-pull converter | 65200                   | 106000 | 146800 | 285500 |        |
| Flyback converter   | 21700                   | 35300  | 48900  | 95100  |        |
| Forward converter   | 32600                   | 53000  | 73400  | 142700 |        |