

PRODUCT DATA APPROVAL SHEET

Appearance & Shape: To be free from any defect such as flow, burrs, unevenness etc, As per IEC standards.

Combination of UI core:



Parameter	Value	Unit
Effective Length (L_e):	258.0	mm
Effective Area (A_e):	448.0	mm ²
Effective Area (A_{min}):	443.0	mm ²
Effective Volume (V_e):	116000	mm ³
Approximate weight(m):	600	g/set

I9316G4 (OL)

Test Conditions: 1kHz/1mT/CFR COIL, N=100/25°C

Material Grade	Initial Permeability (μ_{iac})	AL Value (nH)	μ_e Approx./ Set	P_V (W/set) (25kHz,200mT, 100°C)	P_V (W/set) (100kHz,100mT, 100°C)
CF292	1800±20%	3600 +30%/-20%	≈1650	≤20.3	≤17.40
CF139	2100±20%	4000 +30%/-20%	≈1800	≤11.0	≤13.0
CF297	2300±20%	4250 +30%/-20%	≈1950	≤10.44	≤12.18
CF295	3000±20%	5100 +30%/-20%	≈2300	≤17.40	≤14.50

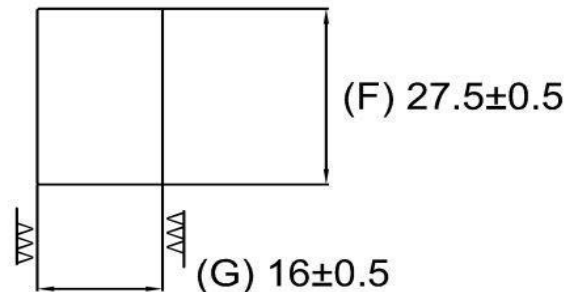
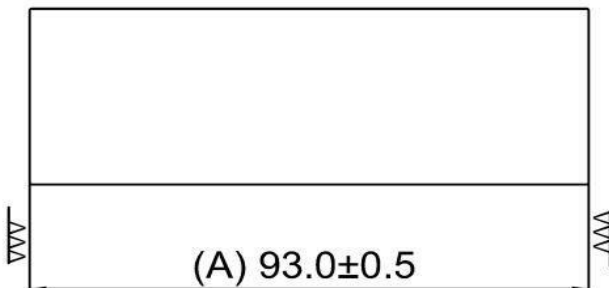

Note : Four sides Grinding