

# H cores

H38. 1X19X12. 7P

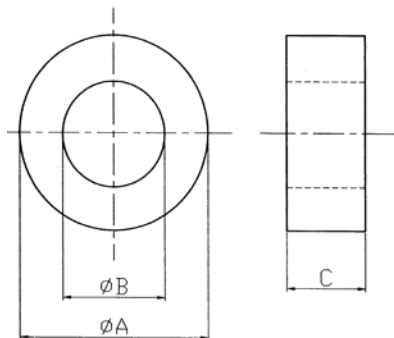

CORE SETS

CORE DIMENSIONS (mm)

Spray paint	Dimensions (mm)		
	$\phi A$	$\phi B$	C
Uncoat	$38.1 \pm 0.6$	$19.0 \pm 0.6$	$12.7 \pm 0.5$
Coat	$38.3 \pm 0.6$	$18.85 \pm 0.6$	$12.9 \pm 0.5$

Effective core parameters

SYMBOL	PARAMETER	VALUE	UNIT
Ve	effective volume	9650.0	mm <sup>3</sup>
le	effective length	82.8	mm
Ae	effective area	117.0	mm <sup>2</sup>
Wt	mass of core set	≈56.6	g

Characteristic

Grade	AL (nH/N <sup>2</sup> )	Z1 (Ω)	Z2 (Ω)
	f=100kHz U=0.25V N=10Ts, $\Phi$ 0.35 mm	f=25MHz N=1Ts $\Phi$ 1.0*100mm T=25±2°C	f=100MHz N=1Ts $\Phi$ 1.0*100mm T=25±2°C
DN160L	2800±25%	50 min	63 min
DN80L	1400±25%	45 min	80 min
DN30L	530±25%	35 min	120 min



**Prodin Ferrite S.L.**

CalleA, 27, 08620 Sant Vicenç dels Horts, Barcelona (Spain)

Tel.: +34 93 672 46 10

[info@prodinferrite.com](mailto:info@prodinferrite.com) [www.prodinferrite.com](http://www.prodinferrite.com)