

# H cores

H36X23X15P

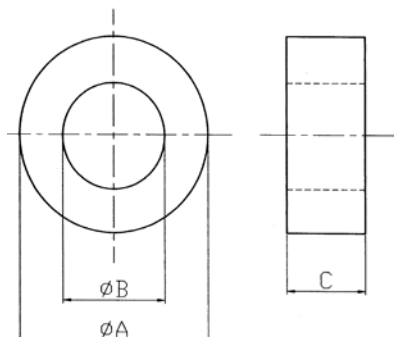

CORE SETS

CORE DIMENSIONS (mm)

Spray paint	Dimensions (mm)		
	$\phi A$	$\phi B$	C
Uncoat	$36.0 \pm 0.8$	$23.0 \pm 0.6$	$15.0 \pm 0.5$
Coat	$36.2 \pm 0.8$	$22.85 \pm 0.6$	$15.2 \pm 0.5$

Effective core parameters

SYMBOL	PARAMETER	VALUE	UNIT
Ve	effective volume	9031.4	mm <sup>3</sup>
le	effective length	94.2	mm
Ae	effective area	95.9	mm <sup>2</sup>
Wt	mass of core set	≈46.1	g

Characteristic

Grade	AL (nH/N <sup>2</sup> )	Z (Ω)
	f=100kHz U=0.25V N=10Ts, $\Phi$ 0.35 mm	f=25MHz N=1Ts $\Phi$ 1.0×100mm T=25±2°C
DN150H	$2000 \pm 25\%$	38 min
DN85H	$1140 \pm 25\%$	35 min
DN65H	$870 \pm 25\%$	30 min
DN10H	$130 \pm 25\%$	20 min



**Prodin Ferrite S.L.**

CalleA, 27, 08620 Sant Vicenç dels Horts, Barcelona (Spain)

Tel.: +34 93 672 46 10

[info@prodinferrite.com](mailto:info@prodinferrite.com) [www.prodinferrite.com](http://www.prodinferrite.com)