

PRODUCT DATA APPROVAL SHEET

Core-CF139EFF3009

Cosmo Ferrites Ltd. -INDIA

Appearance & Shape: To be free from any defect such as flow, burrs, unevenness etc, as per IEC standards.
Effective Parameters irrespective of material grade (per set)

| Parameter | Value | Unit |
|-------------------------------|-------|-----------------|
| Effective Length (L_e): | 68 | mm |
| Effective Area (A_e): | 69 | mm ² |
| Effective Area (A_{min}): | 66.4 | mm ² |
| Effective Volume (V_e): | 4692 | mm ³ |
| Approximate weight(m): | 23.5 | g/set |



"Clamping force for AL measurement is 70 ±20 N, unless otherwise stated"

EFF3009 Un-gapped (OL)

Test Conditions: 1kHz/1mT/CFR COIL, N=100/25 °C

| Material Grade | Initial Permeability (μ_{jac}) | AL Value (nH) | μ_e Approx./Set | P_V (W/set) (100kHz,100mT, 100°C) | P_V (W/set) (100kHz,200mT, 100°C) |
|----------------|--------------------------------------|----------------|---------------------|-------------------------------------|-------------------------------------|
| CF139 | 2100 ±20% | 2100 +30%/-20% | ≈ 1720 | ≤ 0.47 | ≤ 2.6 |

EFF3009 Gapped

Test Conditions: 1kHz/300mV/CFR COIL, N=100/25 °C

| Material Grade | Gap Value in mm/Pc | S, T | | D | |
|----------------|--------------------|---------------------|---------------------|---------------------|---------------------|
| | | AL(nH) Approx. /Set | μ_e Approx./Set | AL(nH) Approx. /Set | μ_e Approx./Set |
| CF139 | 0.19 ±0.02 | ≈ 408 | ≈ 320 | ≈ 249 | ≈ 195 |
| CF139 | 0.27 ±0.04 | ≈ 320 | ≈ 252 | ≈ 197 | ≈ 155 |
| CF139 | 0.38 ±0.02 | ≈ 249 | ≈ 195 | ≈ 152 | ≈ 119 |
| CF139 | 0.71 ±0.04 | ≈ 160 | ≈ 125 | ≈ 97 | ≈ 76 |

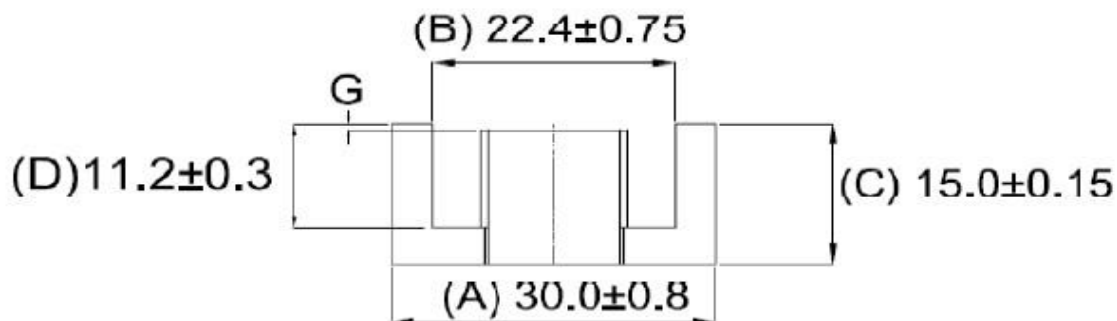
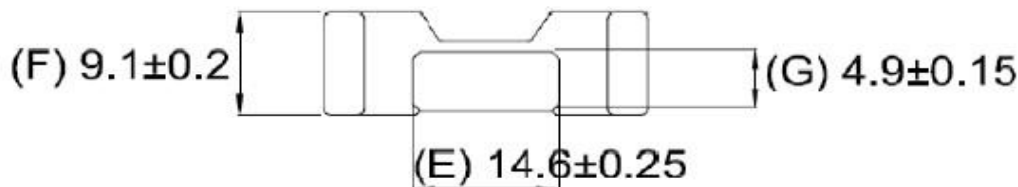

Prodin Ferrite S.L.

Calle A, 27, 08620 Sant Vicenç dels Horts, Barcelona (Spain)

Tel.: +34 93 672 46 10

info@prodinferrite.com www.prodinferrite.com