



PRODUCT DATA APPROVAL SHEET

Core-CF138EE3007

Cosmo Ferrites Ltd. -INDIA

Appearance & Shape: To be free from any defect such as flow, burrs, unevenness etc, as per IEC standards.
Effective Parameters irrespective of material grade (per set)

Parameter	Value	Unit
Effective Length (L_e):	67.0	mm
Effective Area (A_e):	60.0	mm ²
Effective Area (A_{min}):	49.0	mm ²
Effective Volume (V_e):	4000	mm ³
Approximate weight(m):	21	g/set



“Clamping force for AL measurement is 20 ± 10 N, unless otherwise stated”

EE3007 Un-gapped (OL)

Test Conditions: 1kHz/1mT/CFR COIL, N=100/25 °C

Material Grade	Initial Permeability(μ_{iac})	AL Value (nH)	μ_e Approx./Set	P_V (W/set) (100kHz,100mT, 100°C)	P_V (W/set) (100kHz,200mT, 100°C)
CF138	2100 \pm 20%	1900 +30%/-20%	\approx 1720	\leq 0.44	\leq 2.3

EE3007 Gapped

Test Conditions: 1kHz/300mV/CFR COIL, N=100/25 °C

Material Grade	Gap Value in mm/Pc	S, T		D	
		AL(nH) Approx./Set	μ_e Approx./Set	AL(nH) Approx./Set	μ_e Approx./Set
CF138	0.125 \pm 0.02	\approx 390	\approx 344	\approx 238	\approx 210

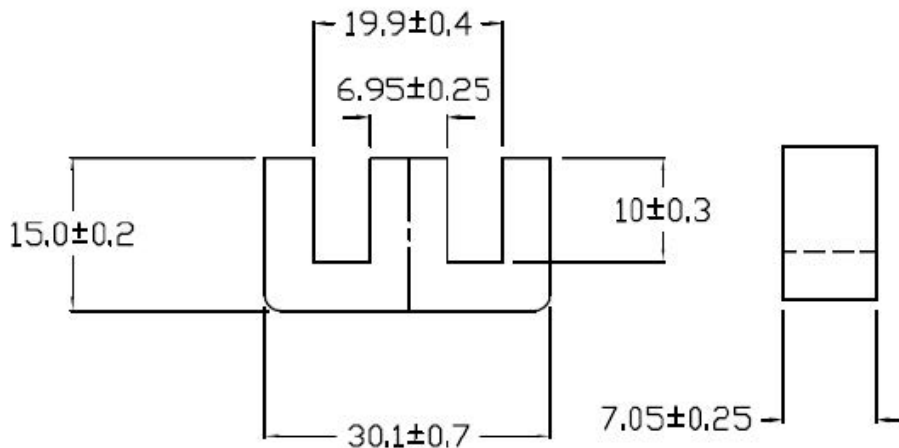

Prodin Ferrite S.L.

Calle A, 27, 08620 Sant Vicenç dels Horts, Barcelona (Spain)

Tel.: +34 93 672 46 10

info@prodinferrite.com www.prodinferrite.com

