

# EE110/18.5

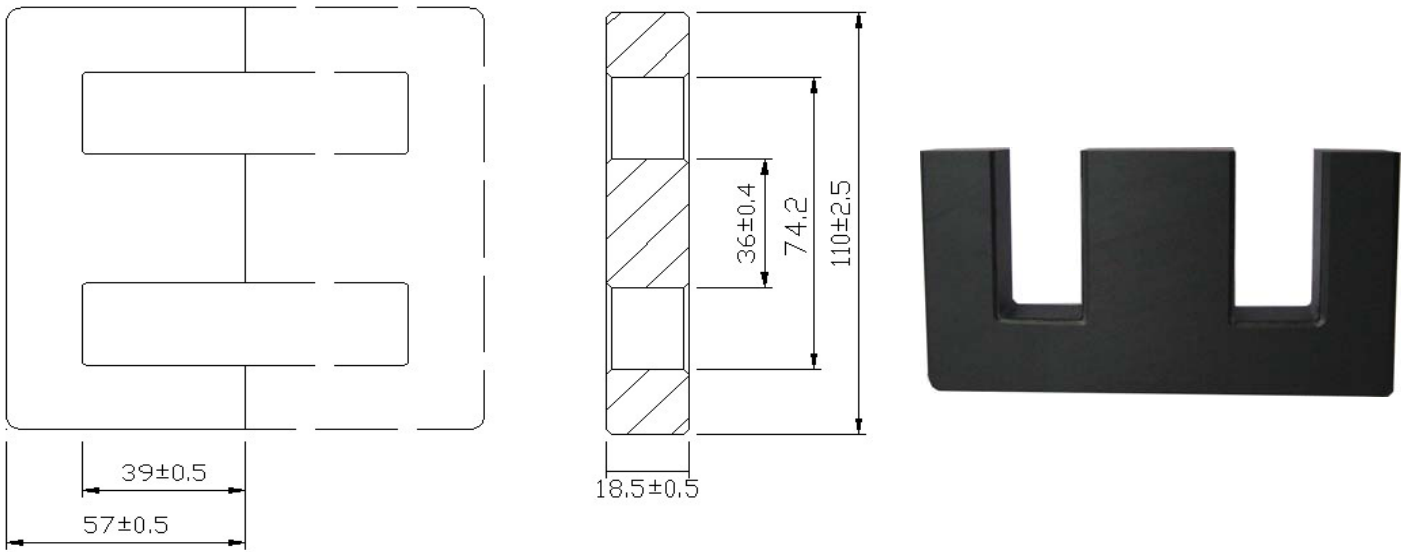

Parameter	Symbol	Value	Unit
Core constant	C1	0.375	mm <sup>-1</sup>
Effective path length	Le	250	mm
Effective area	Ae	666	mm <sup>2</sup>
Effective volume	Ve	174270	mm <sup>3</sup>
Inductance factor	AL	7000	nH/N <sup>2</sup>
Weight of set	W	830	g

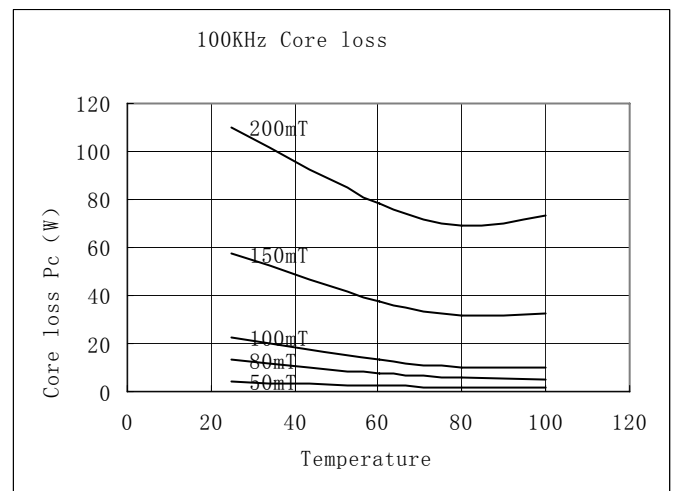
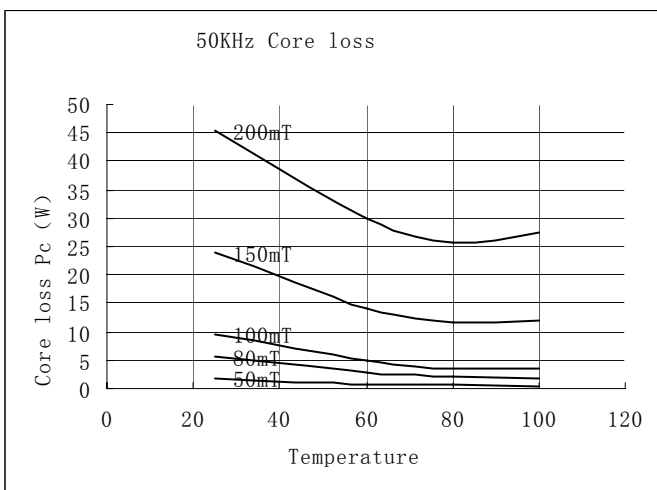

Circuit Type	Calculated Output Power				Unit:W
	Switching Frequency				
	20KHz	50KHz	100KHz	250KHz	
Push-pull converter	6700	10900	15100	29400	
Flyback converter	2200	3600	5000	9800	
Forward converter	3300	5400	7500	14700	

# EE118

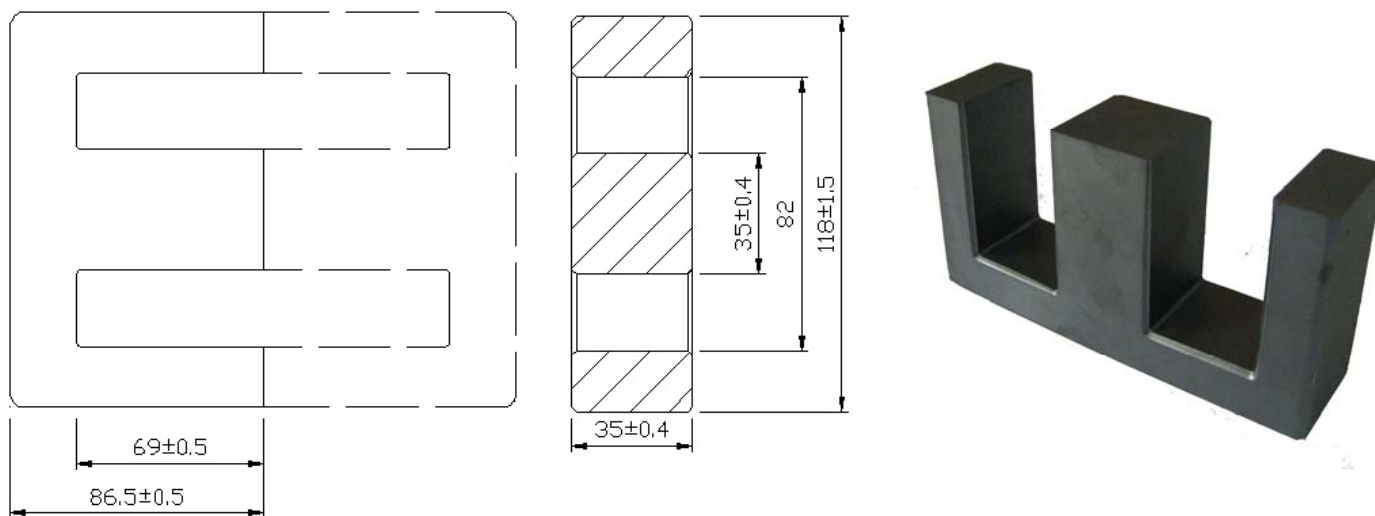

Parameter	Symbol	Value	Unit
Core constant	C1	0.31	mm <sup>-1</sup>
Effective path length	Le	375	mm
Effective area	Ae	1225	mm <sup>2</sup>
Effective volume	Ve	487480	mm <sup>3</sup>
Inductance factor	AL	8500	nH/N <sup>2</sup>
Weight of set	W	2320	g

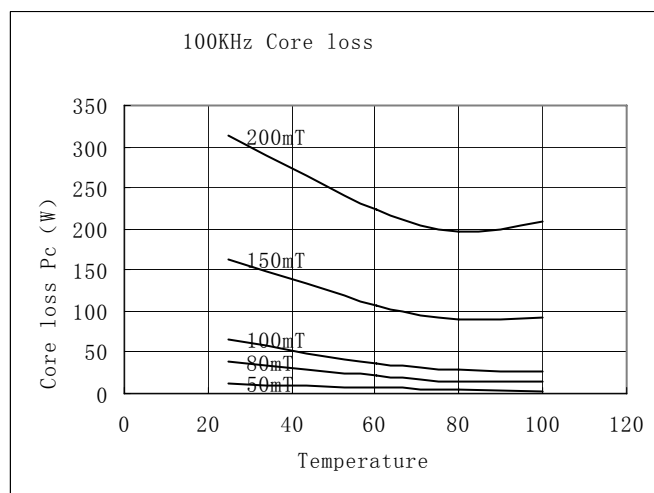
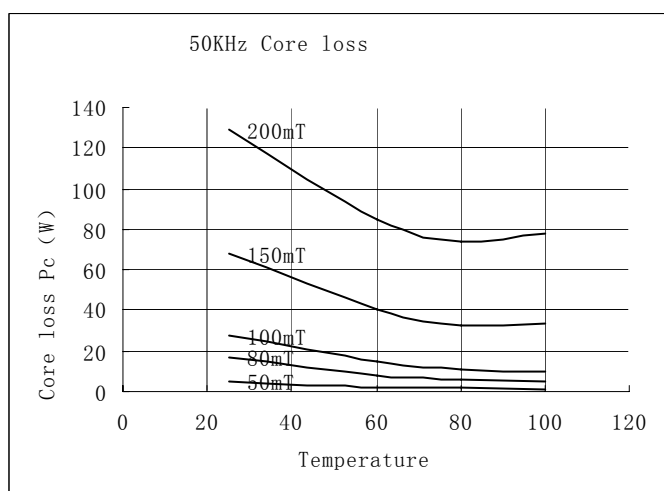

Circuit Type	Calculated Output Power				Unit:W
	Switching Frequency				
	20KHz	50KHz	100KHz	250KHz	
Push-pull converter	25700	41800	57800	112500	
Flyback converter	8500	13900	19200	37500	
Forward converter	12800	20900	28900	56200	

# EE120

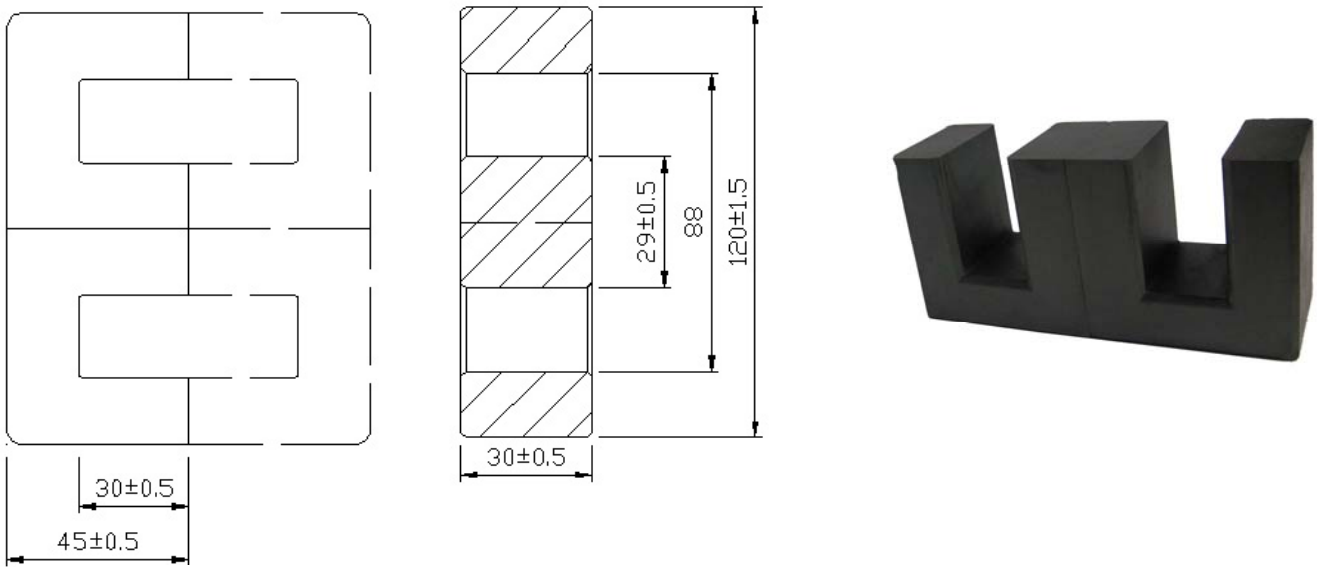

Parameter	Symbol	Value	Unit
Core constant	C1	0.247	mm <sup>-1</sup>
Effective path length	Le	223	mm
Effective area	Ae	900	mm <sup>2</sup>
Effective volume	Ve	219600	mm <sup>3</sup>
Inductance factor	AL	10200	nH/N <sup>2</sup>
Weight of set	W	1050	g

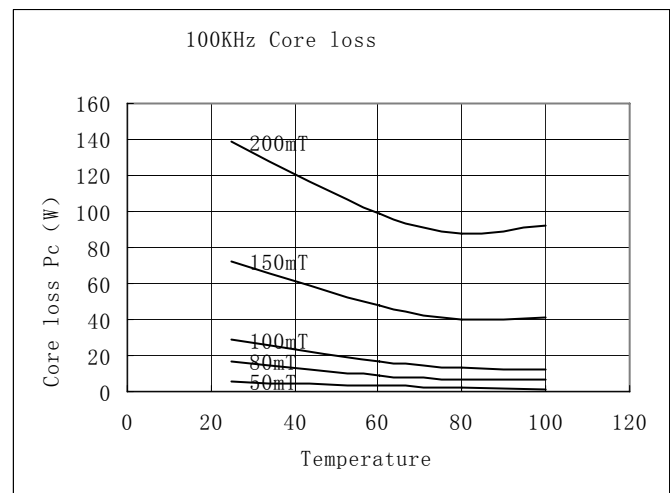
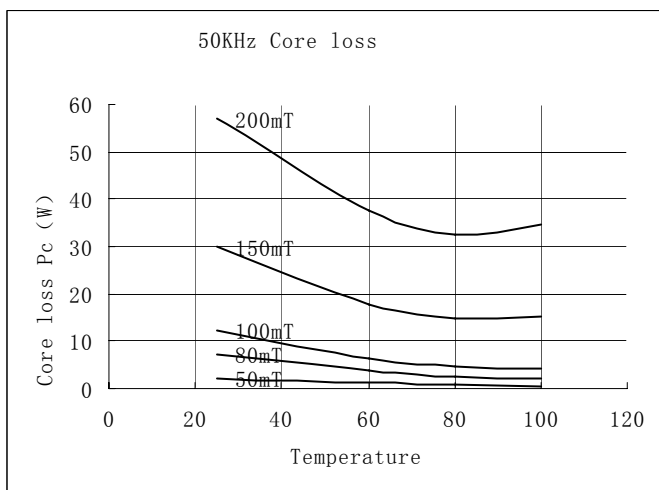

Circuit Type	Calculated Output Power				Unit:W
	Switching Frequency				
	20KHz	50KHz	100KHz	250KHz	
Push-pull converter	10100	16400	22800	44300	
Flyback converter	3300	5400	7600	14700	
Forward converter	5000	8200	11400	22100	

# EE128

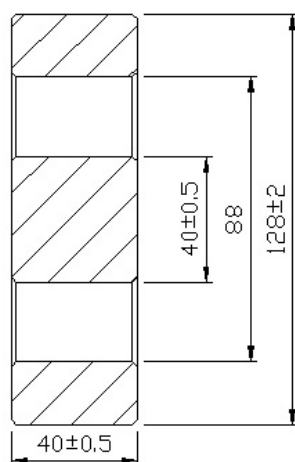
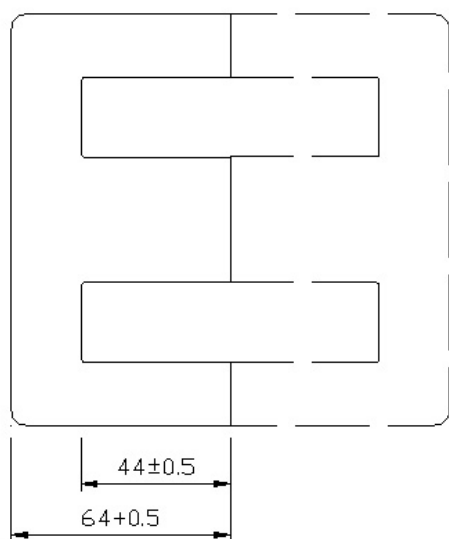

Parameter	Symbol	Value	Unit
Core constant	C1	0.177	mm <sup>-1</sup>
Effective path length	Le	284	mm
Effective area	Ae	1600	mm <sup>2</sup>
Effective volume	Ve	486400	mm <sup>3</sup>
Inductance factor	AL	14000	nH/N <sup>2</sup>
Weight of set	W	2330	g

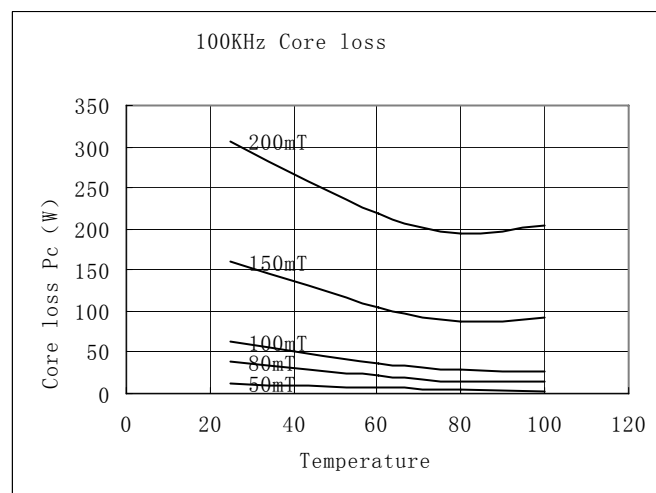
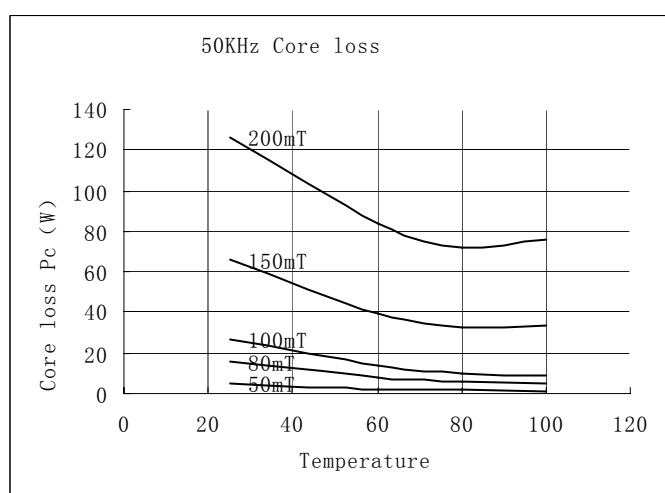

Circuit Type	Calculated Output Power				Unit:W
	Switching Frequency				
	20KHz	50KHz	100KHz	250KHz	
Push-pull converter	21800	35500	49200	95700	
Flyback converter	7200	11800	16400	31900	
Forward converter	10900	17700	24600	47800	

# EE130

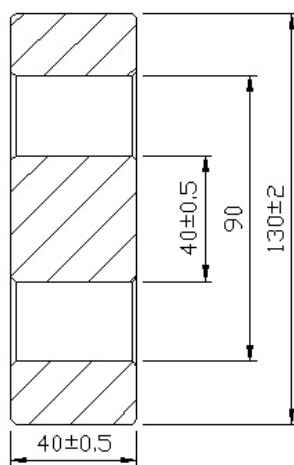
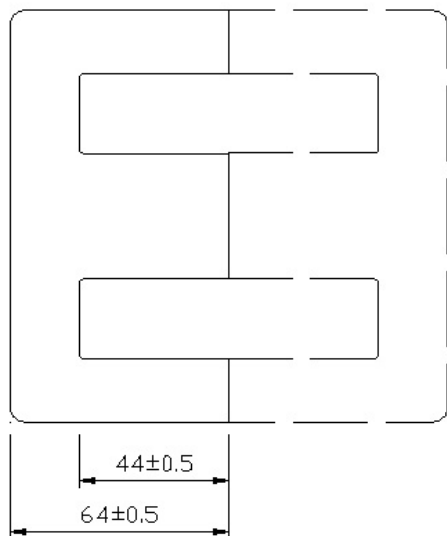

Parameter	Symbol	Value	Unit
Core constant	C1	0.179	mm <sup>-1</sup>
Effective path length	Le	286	mm
Effective area	Ae	1600	mm <sup>2</sup>
Effective volume	Ve	489600	mm <sup>3</sup>
Inductance factor	AL	14000	nH/N <sup>2</sup>
Weight of set	W	2340	g

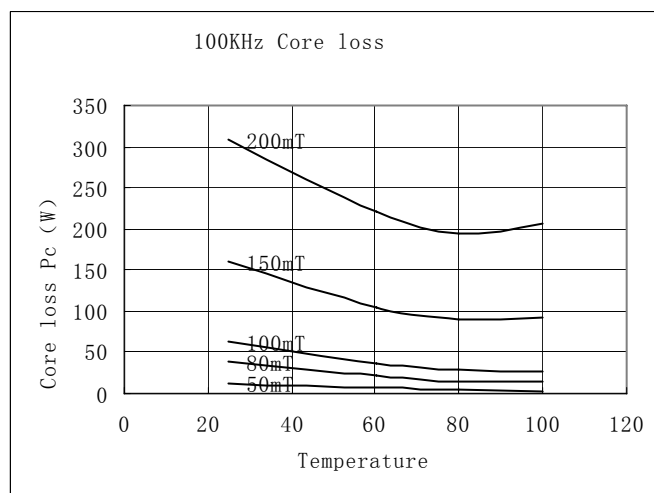
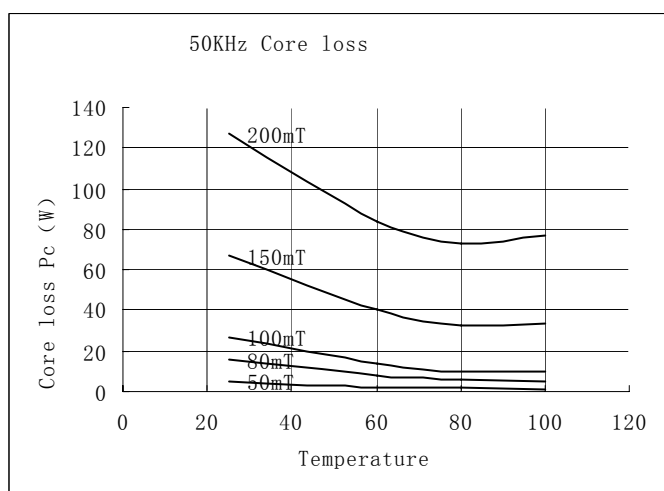

Circuit Type	Calculated Output Power				Unit:W
	Switching Frequency				
	20KHz	50KHz	100KHz	250KHz	
Push-pull converter	22700	37000	51200	99700	
Flyback converter	7500	12300	17000	33200	
Forward converter	11300	18500	25600	49800	

# EEL130

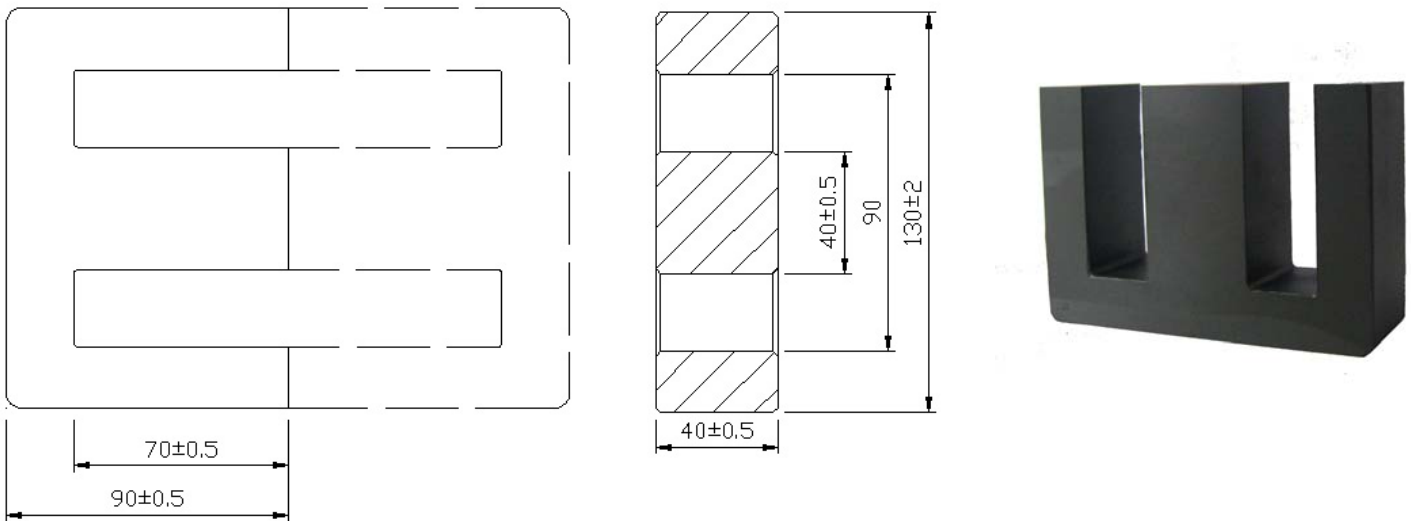

Parameter	Symbol	Value	Unit
Core constant	C1	0.243	mm <sup>-1</sup>
Effective path length	Le	390	mm
Effective area	Ae	1600	mm <sup>2</sup>
Effective volume	Ve	656000	mm <sup>3</sup>
Inductance factor	AL	10700	nH/N <sup>2</sup>
Weight of set	W	3140	g

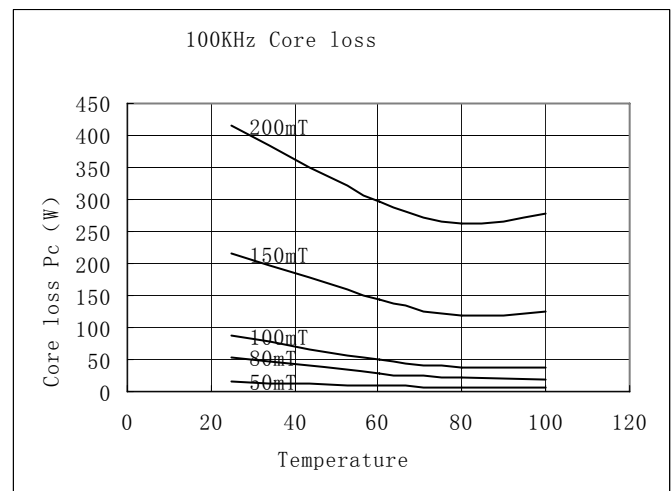
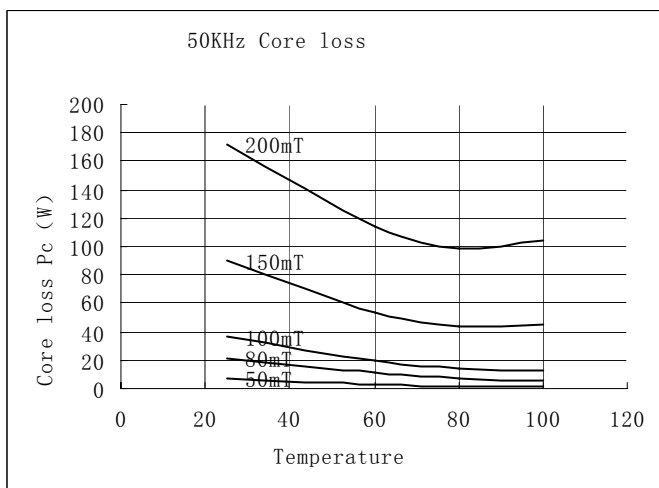

Circuit Type	Calculated Output Power				Unit:W
	Switching Frequency				
	20KHz	50KHz	100KHz	250KHz	
Push-pull converter	35700	58000	80400	156300	
Flyback converter	11900	19300	26800	52100	
Forward converter	17800	29000	40200	78100	

# EE140

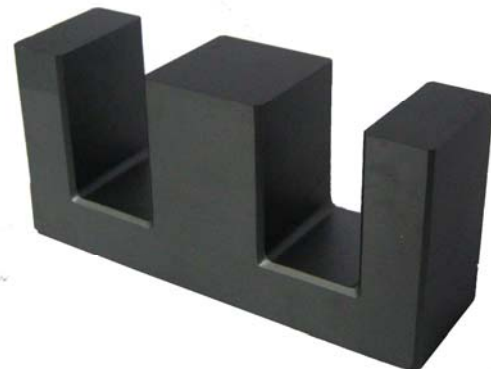
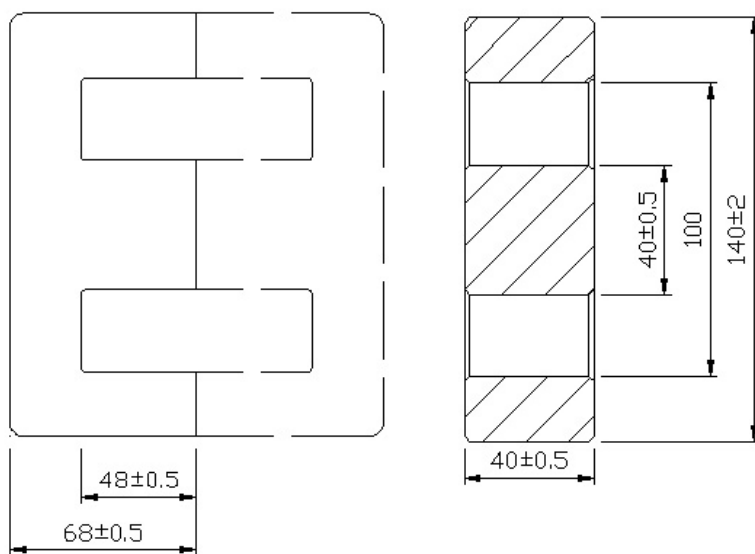

Parameter	Symbol	Value	Unit
Core constant	C1	0.195	mm <sup>-1</sup>
Effective path length	Le	312	mm
Effective area	Ae	1600	mm <sup>2</sup>
Effective volume	Ve	531200	mm <sup>3</sup>
Inductance factor	AL	13000	nH/N <sup>2</sup>
Weight of set	W	2550	g

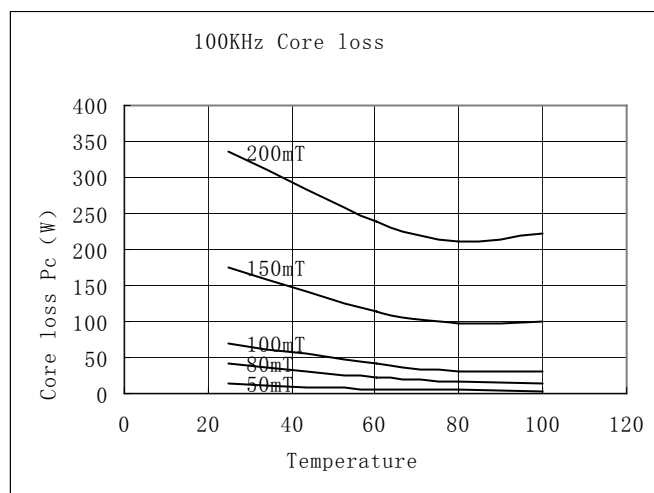
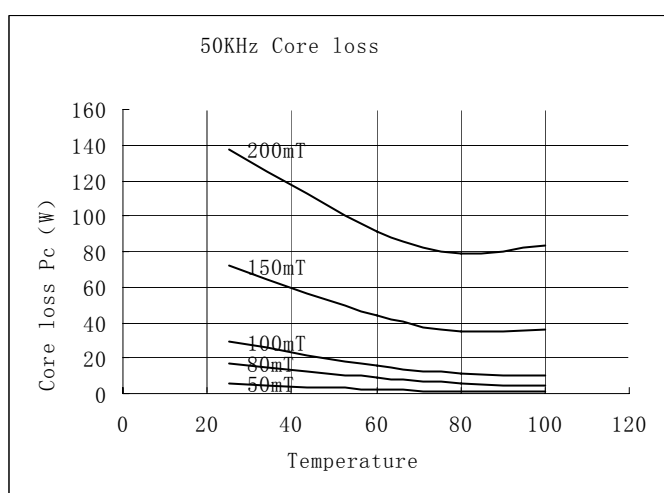

Circuit Type	Calculated Output Power				Unit:W
	Switching Frequency				
	20KHz	50KHz	100KHz	250KHz	
Push-pull converter	29800	48400	67100	130500	
Flyback converter	9900	16100	22300	43500	
Forward converter	14900	24200	33500	65200	

# EE150

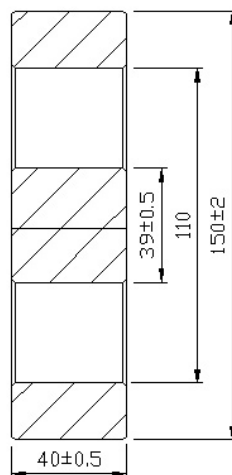
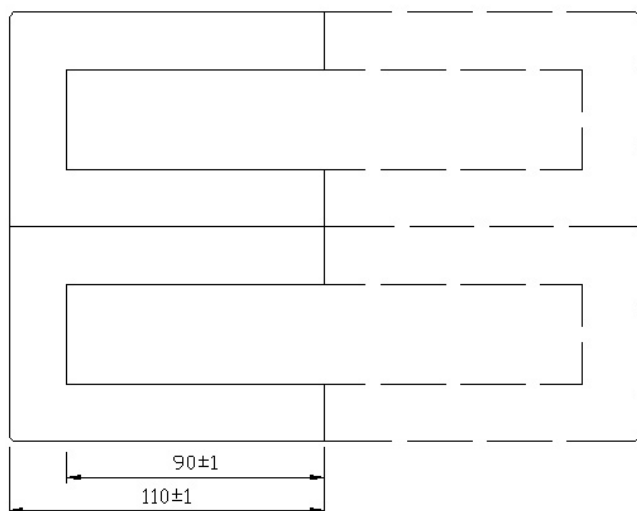

Parameter	Symbol	Value	Unit
Core constant	C1	0.3	mm <sup>-1</sup>
Effective path length	Le	490	mm
Effective area	Ae	1560	mm <sup>2</sup>
Effective volume	Ve	808800	mm <sup>3</sup>
Inductance factor	AL	8300	nH/N <sup>2</sup>
Weight of set	W	3916	g

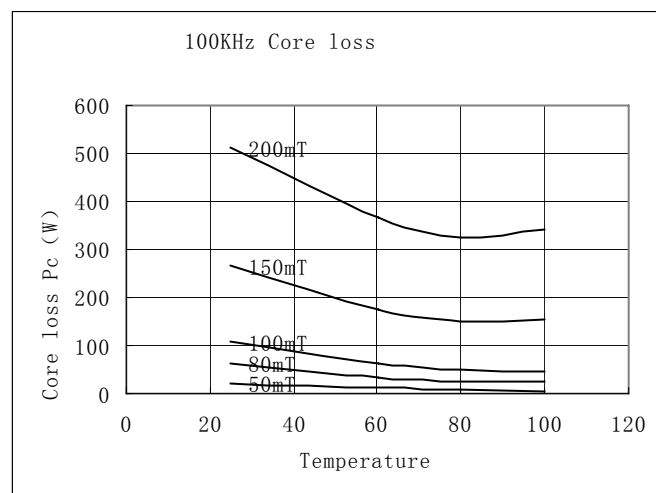
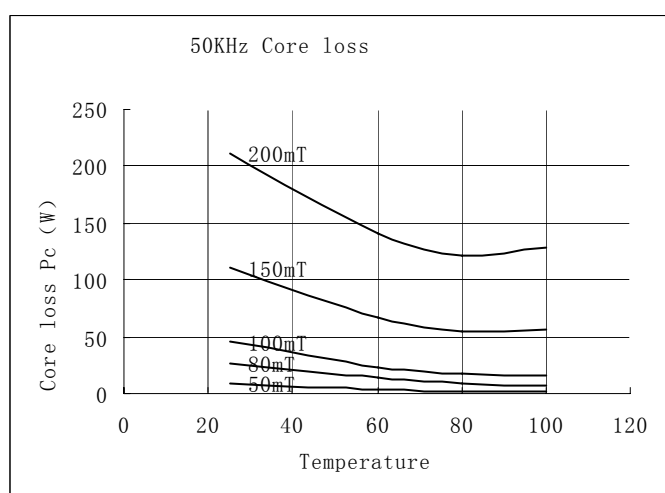

Circuit Type	Calculated Output Power				Unit:W
	Switching Frequency				
	20KHz	50KHz	100KHz	250KHz	
Push-pull converter	65200	106000	146800	285500	
Flyback converter	21700	35300	48900	95100	
Forward converter	32600	53000	73400	142700	



# EE160A

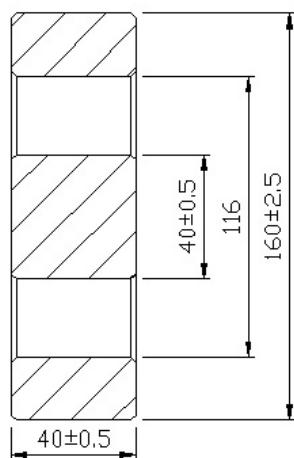
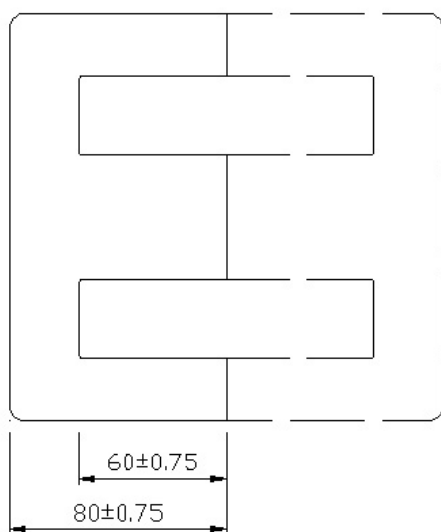

Parameter	Symbol	Value	Unit
Core constant	C1	0.235	mm <sup>-1</sup>
Effective path length	Le	376	mm
Effective area	Ae	1600	mm <sup>2</sup>
Effective volume	Ve	659200	mm <sup>3</sup>
Inductance factor	AL	10800	nH/N <sup>2</sup>
Weight of set	W	3160	g

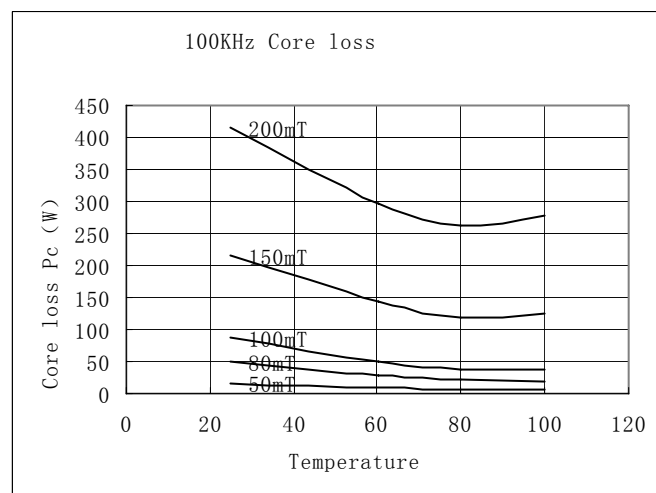
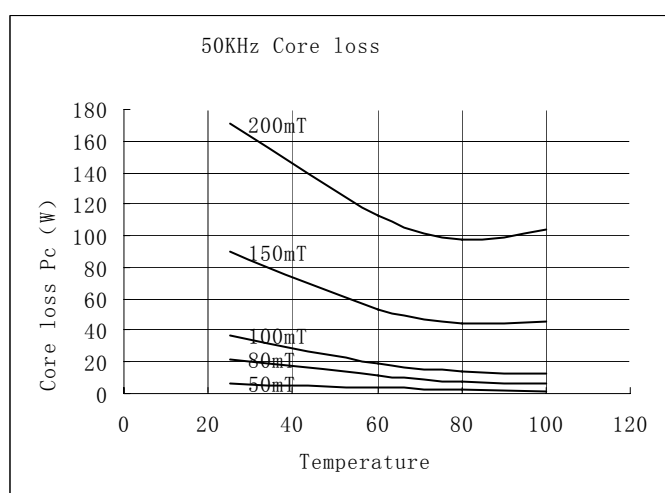

Circuit Type	Calculated Output Power				Unit: W
	Switching Frequency				
	20KHz	50KHz	100KHz	250KHz	
Push-pull converter	47200	76700	106300	206600	
Flyback converter	15700	25500	35400	68800	
Forward converter	23600	38300	53100	103300	

# EE160B

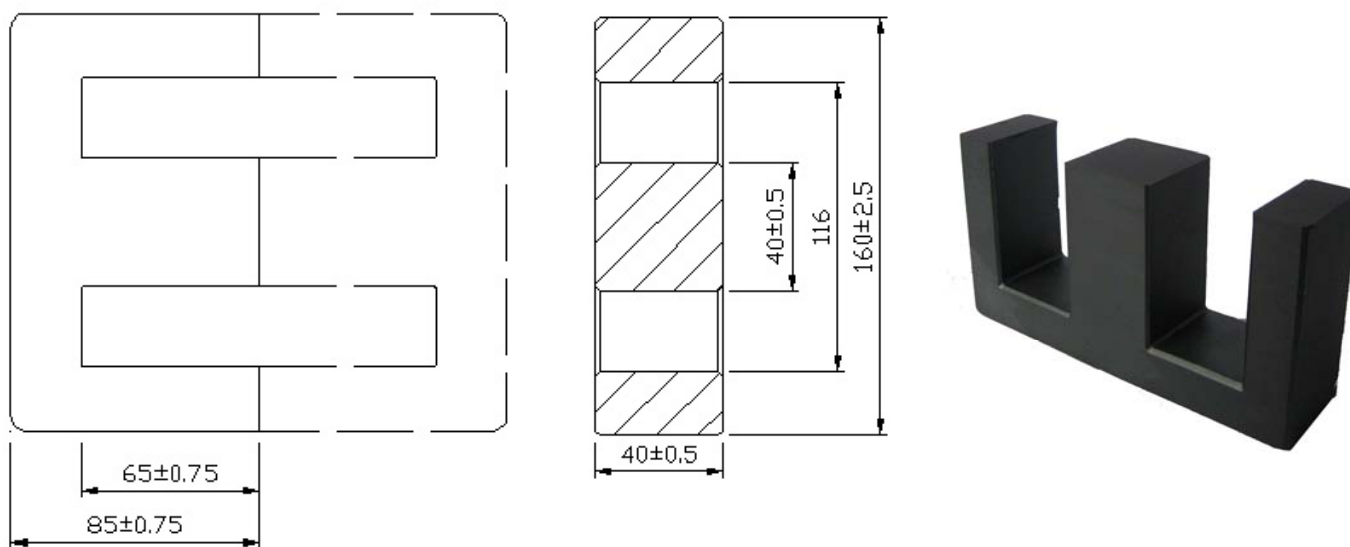

Parameter	Symbol	Value	Unit
Core constant	C1	0.245	mm <sup>-1</sup>
Effective path length	Le	396	mm
Effective area	Ae	1600	mm <sup>2</sup>
Effective volume	Ve	692800	mm <sup>3</sup>
Inductance factor	AL	10500	nH/N <sup>2</sup>
Weight of set	W	3320	g

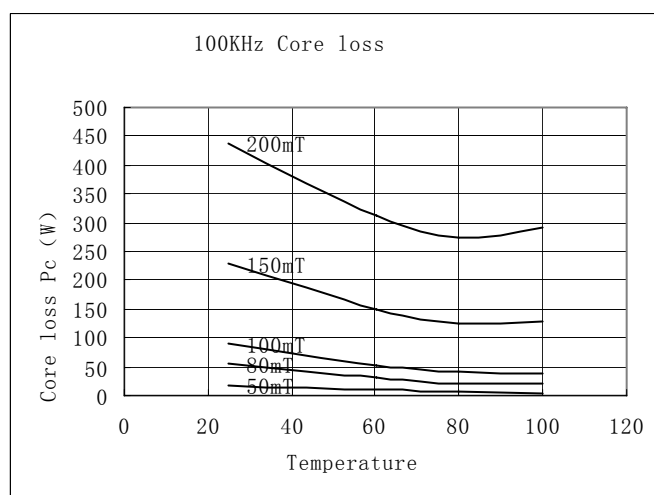
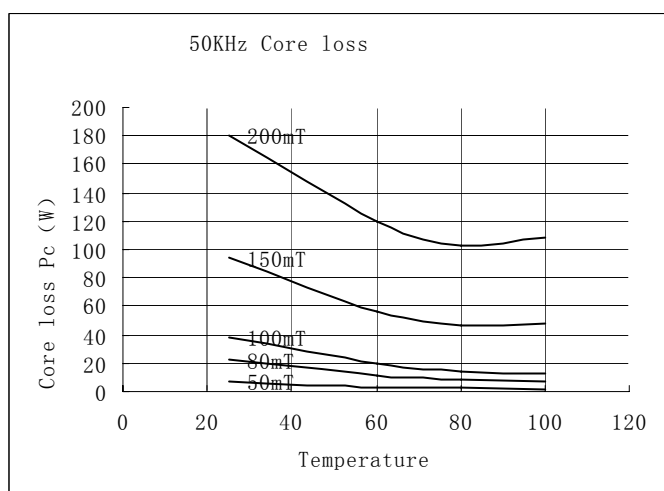

Circuit Type	Calculated Output Power				Unit:W
	Switching Frequency				
	20KHz	50KHz	100KHz	250KHz	
Push-pull converter	51100	83100	115100	223900	
Flyback converter	17000	27700	38300	74600	
Forward converter	25500	41500	57500	111900	

# EE160C

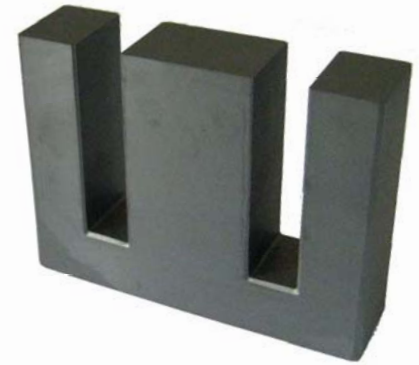
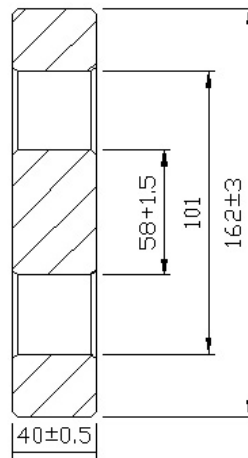
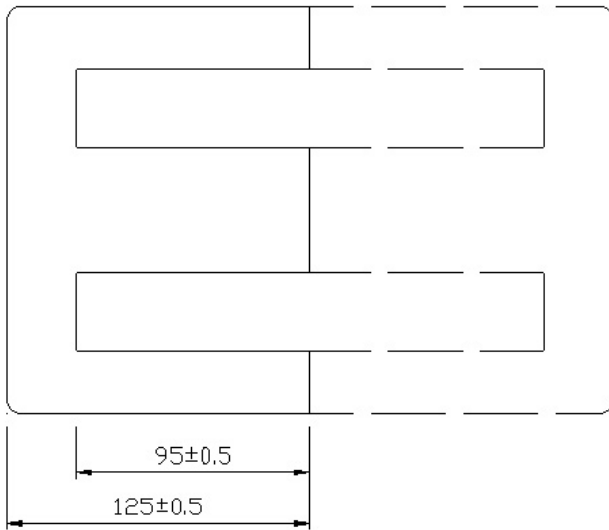

Parameter	Symbol	Value	Unit
Core constant	C1	0.212	mm <sup>-1</sup>
Effective path length	Le	511	mm
Effective area	Ae	2400	mm <sup>2</sup>
Effective volume	Ve	1308400	mm <sup>3</sup>
Inductance factor	AL	12000	nH/N <sup>2</sup>
Weight of set	W	6250	g

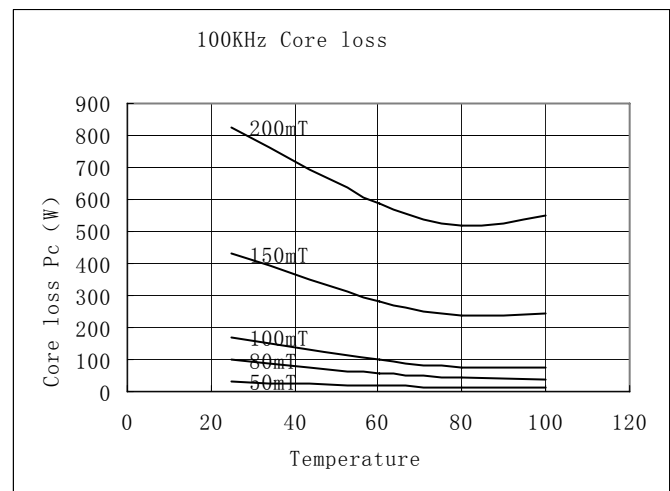
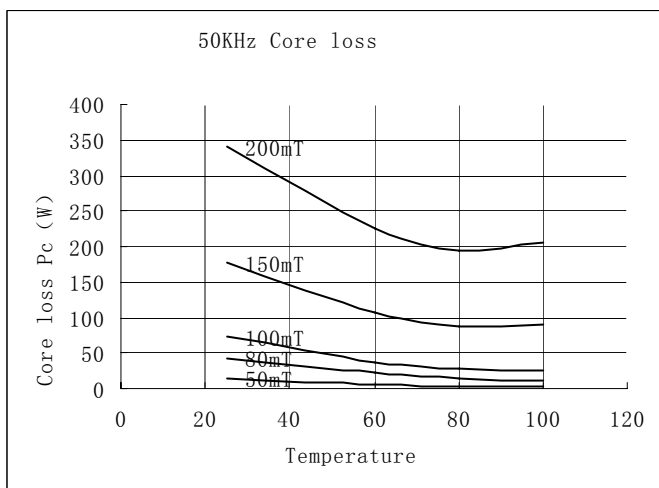

Circuit Type	Calculated Output Power				Unit W
	Switching Frequency				
	20KHz	50KHz	100KHz	250KHz	
Push-pull converter	63400	103100	142800	277700	
Flyback converter	21100	34300	47600	92500	
Forward converter	31700	51500	71400	138800	

# EE168

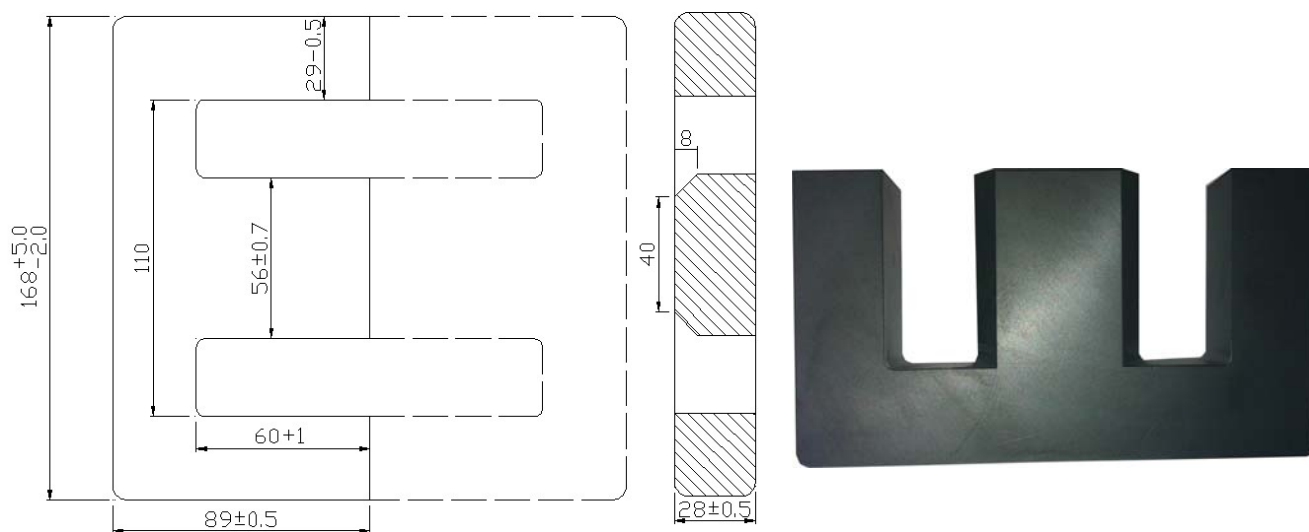

Parameter	Symbol	Value	Unit
Core constant	C1	0.24	mm <sup>-1</sup>
Effective path length	Le	378	mm
Effective area	Ae	1568	mm <sup>2</sup>
Effective volume	Ve	655872	mm <sup>3</sup>
Inductance factor	AL	12075	nH/N <sup>2</sup>
Weight of set	W	3148	g

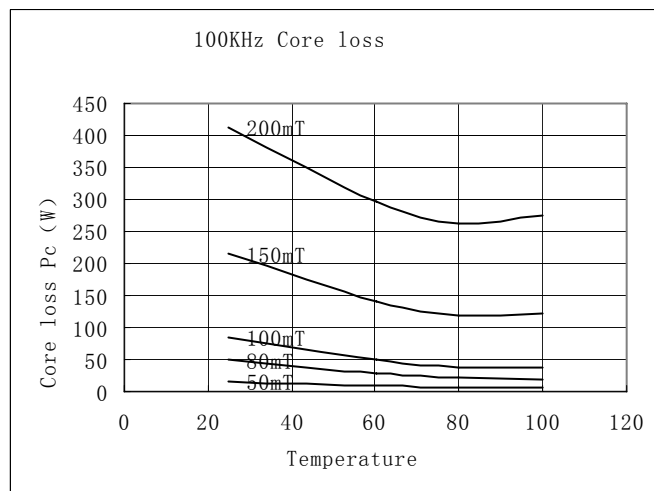
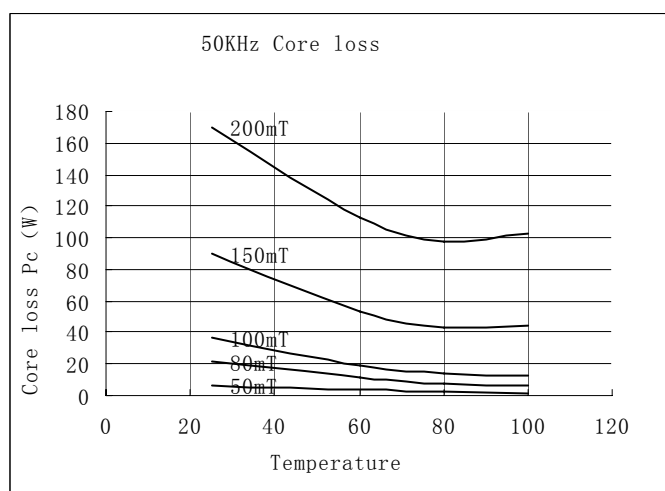

Circuit Type	Calculated Output Power				Unit W
	Switching Frequency				
	20KHz	50KHz	100KHz	250KHz	
Push-pull converter	32900	53400	74000	143900	
Flyback converter	10900	17800	24600	47900	
Forward converter	16400	26700	37000	71900	

# EE180

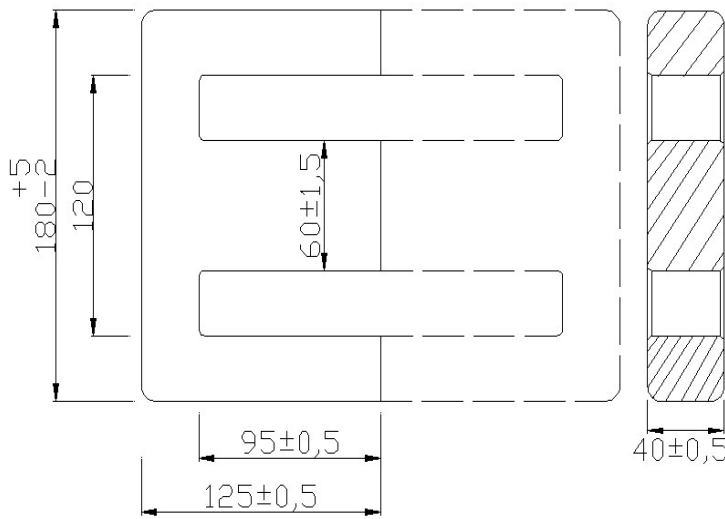

Parameter	Symbol	Value	Unit
Core constant	C1	0.22	mm <sup>-1</sup>
Effective path length	Le	530	mm
Effective area	Ae	2400	mm <sup>2</sup>
Effective volume	Ve	1344000	mm <sup>3</sup>
Inductance factor	AL	13091	nH/N <sup>2</sup>
Weight of set	W	6451	g

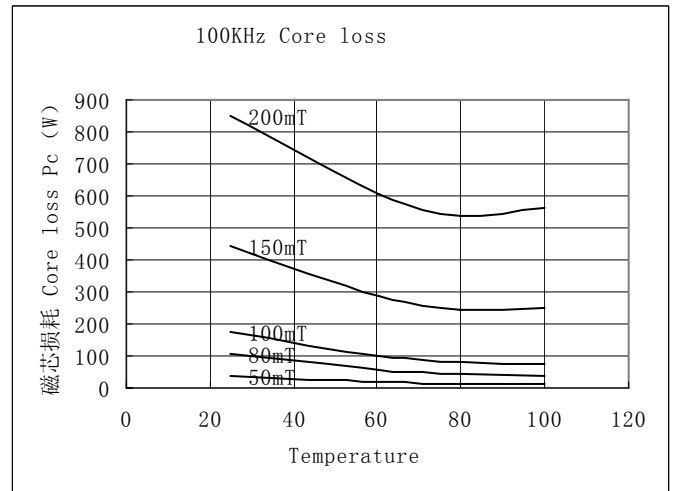
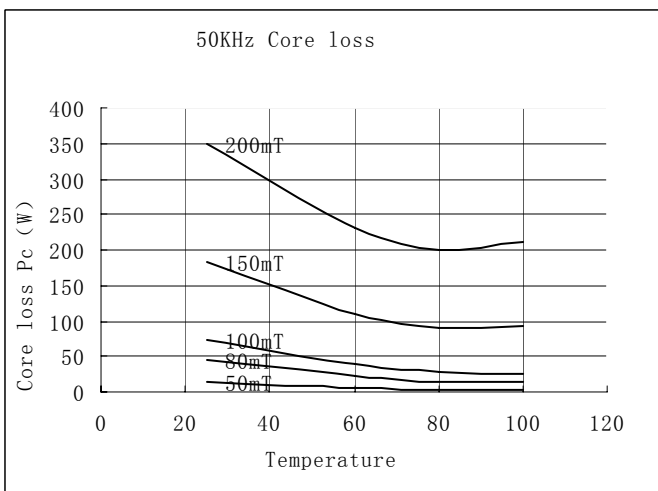

Circuit Type	Calculated Output Power				Unit W
	Switching Frequency				
	20KHz	50KHz	100KHz	250KHz	
Push-pull converter	88600	143900	199300	387500	
Flyback converter	29500	47900	66400	129100	
Forward converter	44300	71900	99600	193700	

# EE188/27

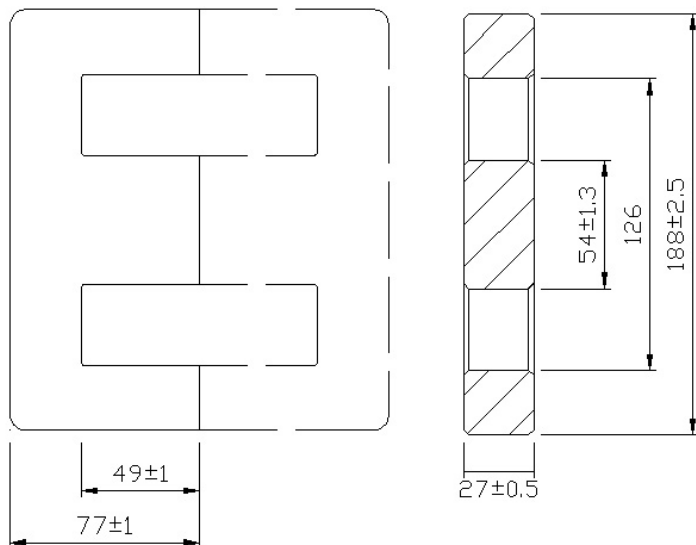

Parameter	Symbol	Value	Unit
Core constant	C1	0.239	mm <sup>-1</sup>
Effective path length	Le	349	mm
Effective area	Ae	1458	mm <sup>2</sup>
Effective volume	Ve	591192	mm <sup>3</sup>
Inductance factor	AL	10700	nH/N <sup>2</sup>
Weight of set	W	2830	g

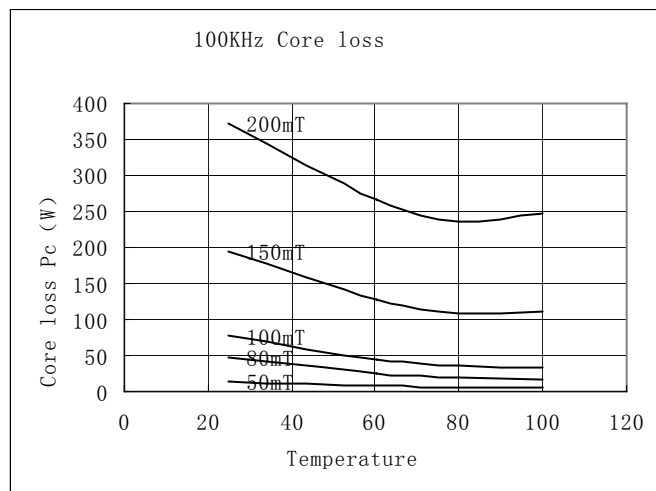
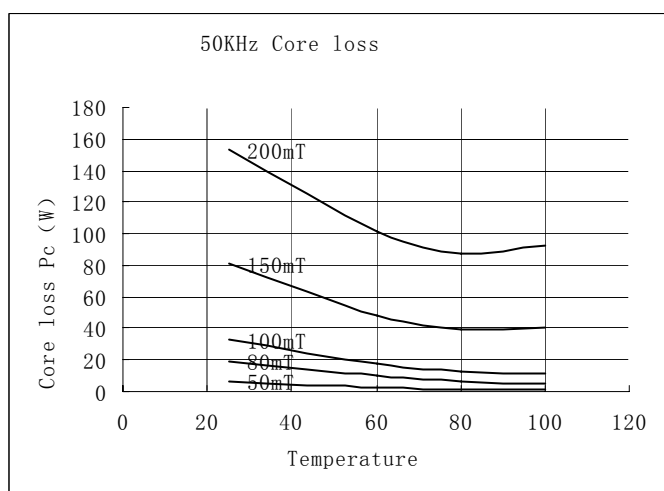

Circuit Type	Calculated Output Power				Unit W
	Switching Frequency				
	20KHz	50KHz	100KHz	250KHz	
Push-pull converter	33300	54100	74900	145700	
Flyback converter	11100	18000	24900	48500	
Forward converter	16600	27000	37400	72800	

# EE188/54

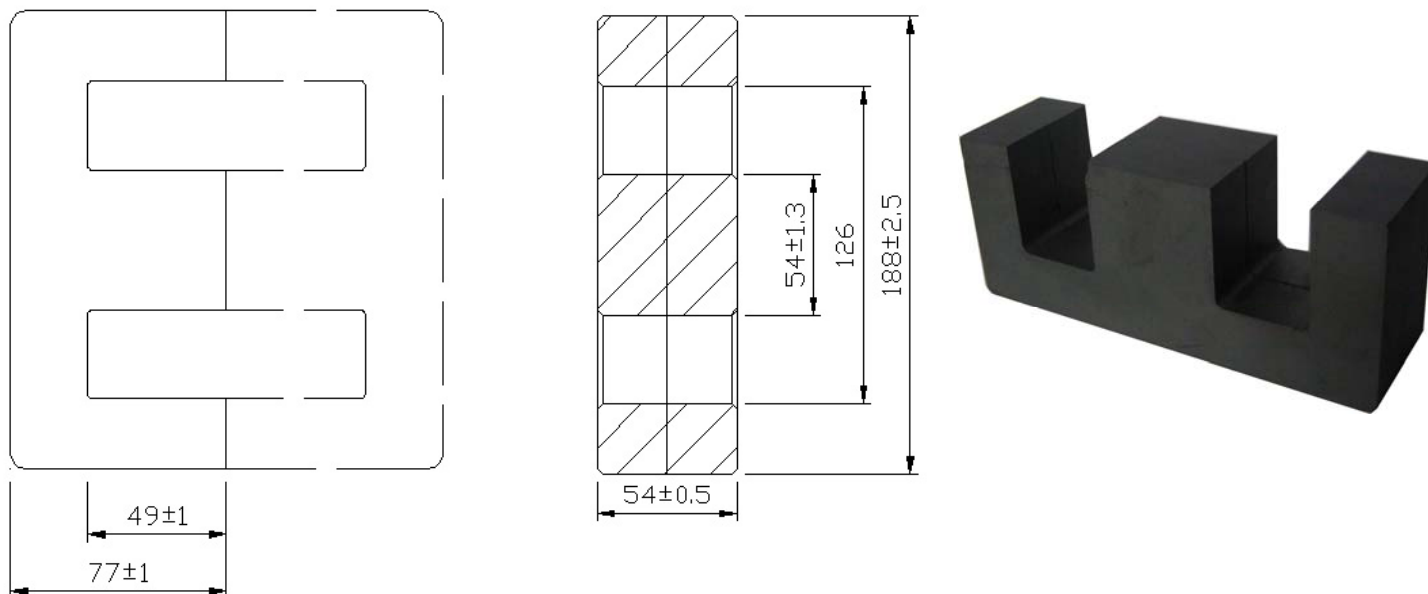

Parameter	Symbol	Value	Unit
Core constant	C1	0.118	mm <sup>-1</sup>
Effective path length	Le	349	mm
Effective area	Ae	2916	mm <sup>2</sup>
Effective volume	Ve	1182384	mm <sup>3</sup>
Inductance factor	AL	21500	nH/N <sup>2</sup>
Weight of set	W	5650	g

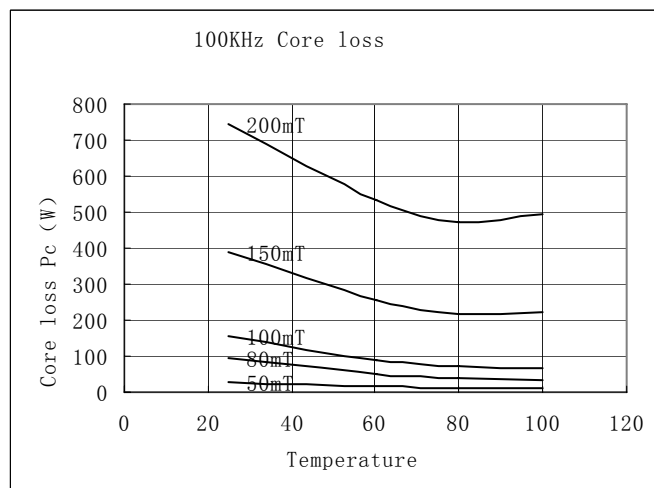
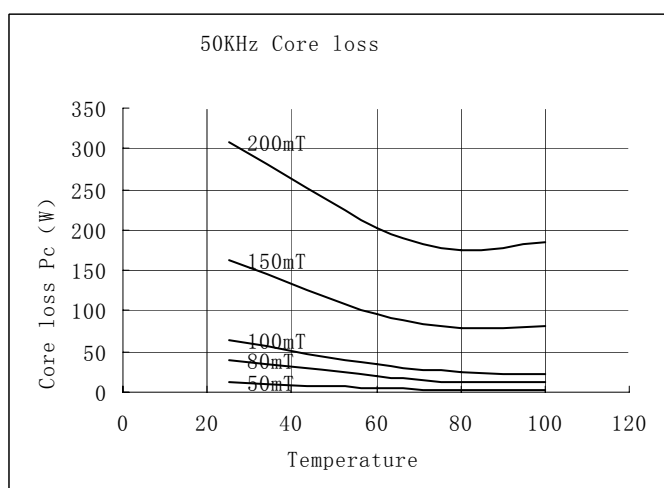

Circuit Type	Calculated Output Power				Unit W
	Switching Frequency				
	20KHz	50KHz	100KHz	250KHz	
Push-pull converter	66600	10800	149900	291400	
Flyback converter	22200	36000	49900	97100	
Forward converter	33300	54100	74900	145700	

# EE193/30

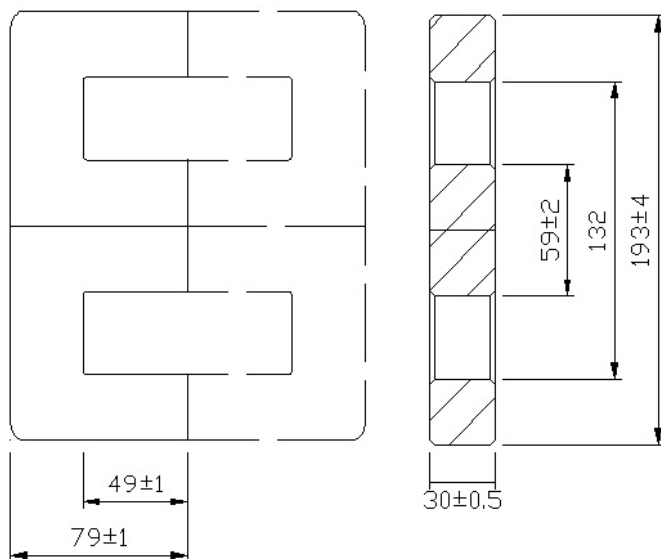

Parameter	Symbol	Value	Unit
Core constant	C1	0.201	mm <sup>-1</sup>
Effective path length	Le	358	mm
Effective area	Ae	1770	mm <sup>2</sup>
Effective volume	Ve	700200	mm <sup>3</sup>
Inductance factor	AL	13000	nH/N <sup>2</sup>
Weight of set	W	3370	g

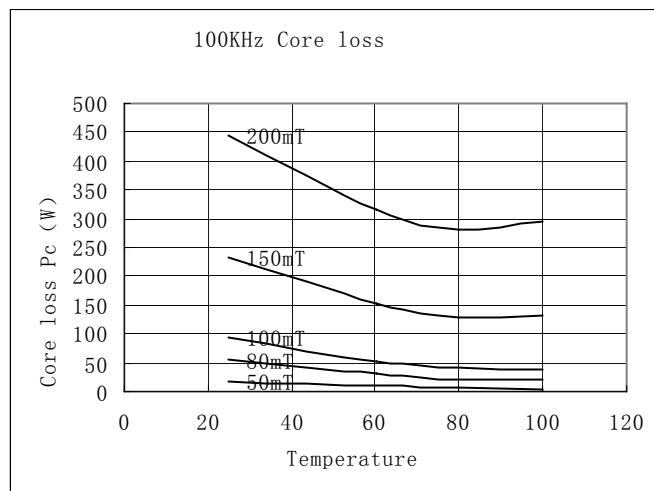
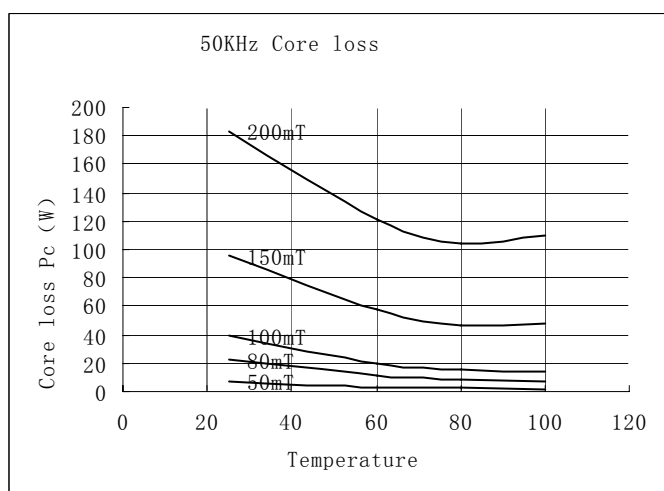

Circuit Type	Calculated Output Power				Unit W
	Switching Frequency				
	20KHz	50KHz	100KHz	250KHz	
Push-pull converter	41100	66800	92500	179900	
Flyback converter	13700	22200	30800	59900	
Forward converter	20500	33400	46200	89900	



# EE193/60

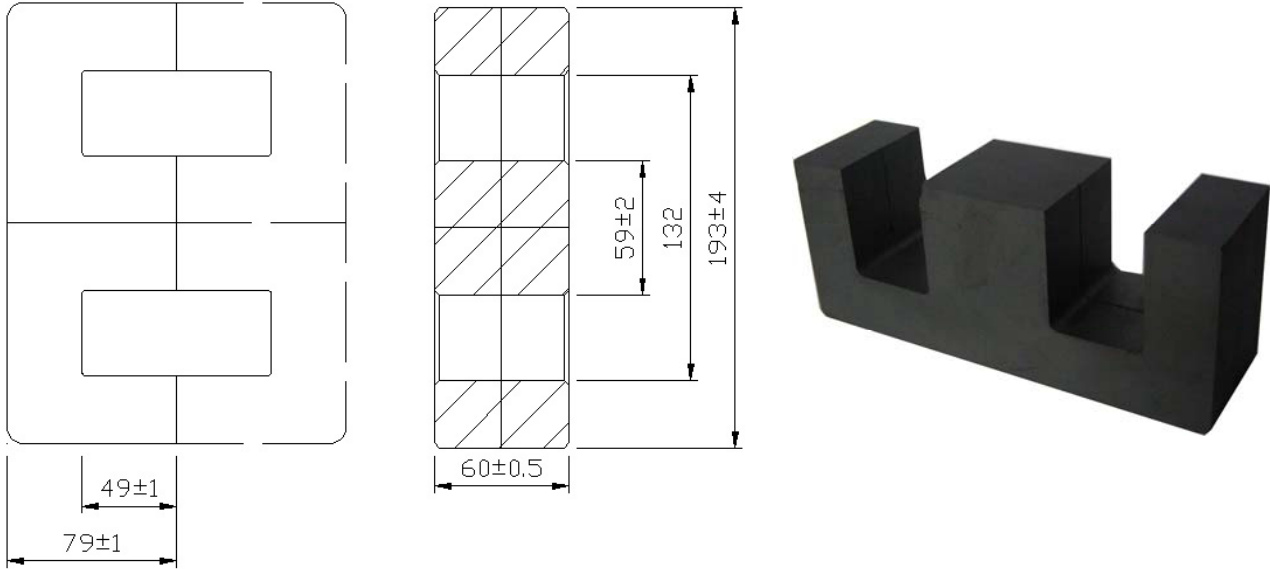

Parameter	Symbol	Value	Unit
Core constant	C1	0.099	mm <sup>-1</sup>
Effective path length	Le	358	mm
Effective area	Ae	3540	mm <sup>2</sup>
Effective volume	Ve	1400400	mm <sup>3</sup>
Inductance factor	AL	26000	nH/N <sup>2</sup>
Weight of set	W	6750	g

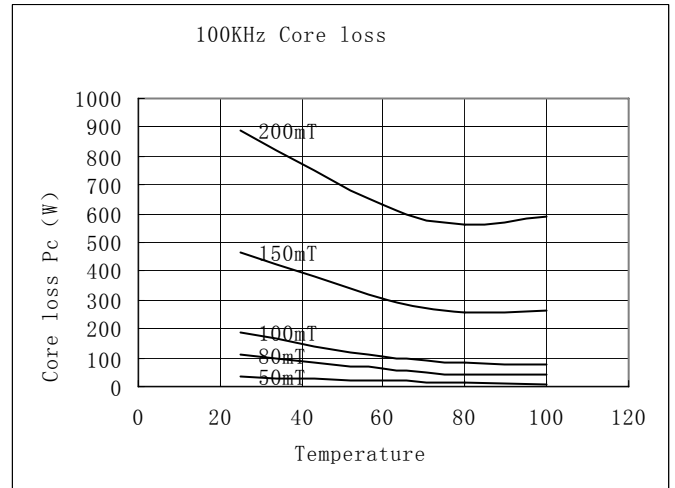
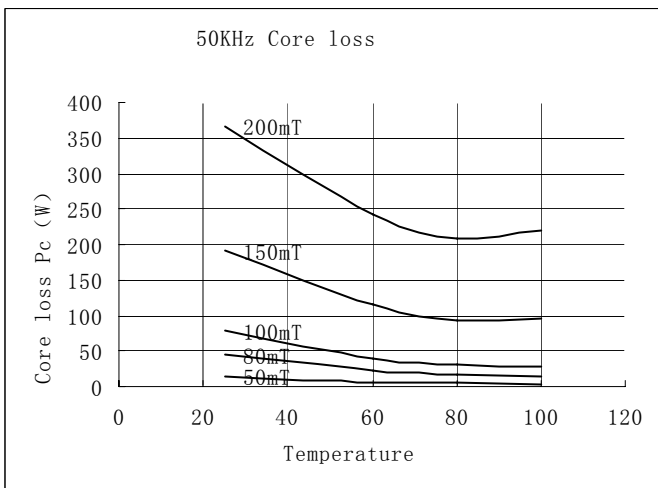

Circuit Type	Calculated Output Power				Unit W
	Switching Frequency				
	20KHz	50KHz	100KHz	250KHz	
Push-pull converter	83400	135500	187600	364800	
Flyback converter	27800	45100	62500	121600	
Forward converter	41700	67700	93800	182400	

# EE200

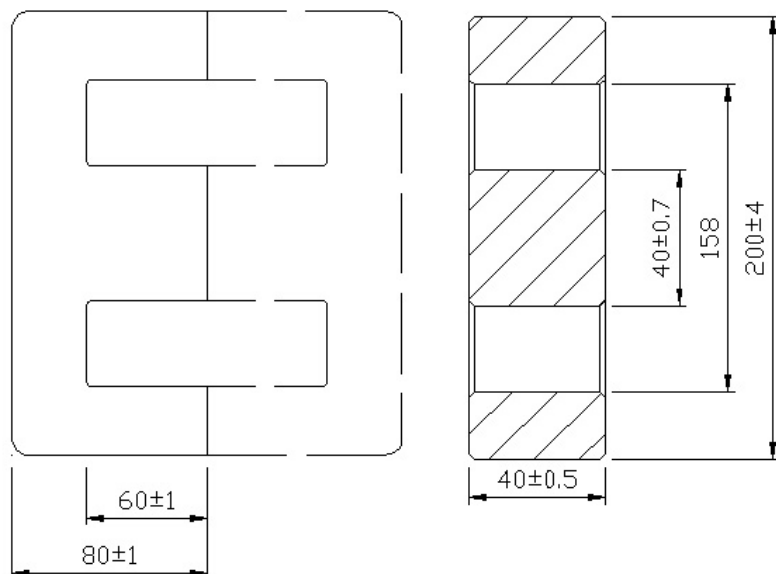

Parameter	Symbol	Value	Unit
Core constant	C1	0.261	$\text{mm}^{-1}$
Effective path length	Le	418	mm
Effective area	Ae	1600	$\text{mm}^2$
Effective volume	Ve	713600	$\text{mm}^3$
Inductance factor	AL	10000	$\text{nH/N}^2$
Weight of set	W	3420	g

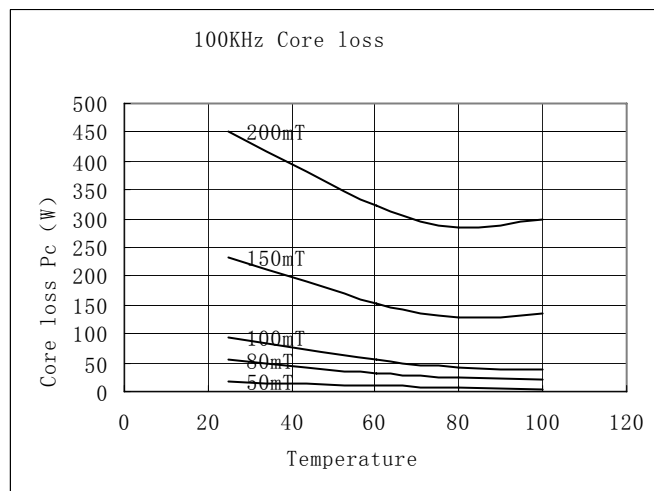
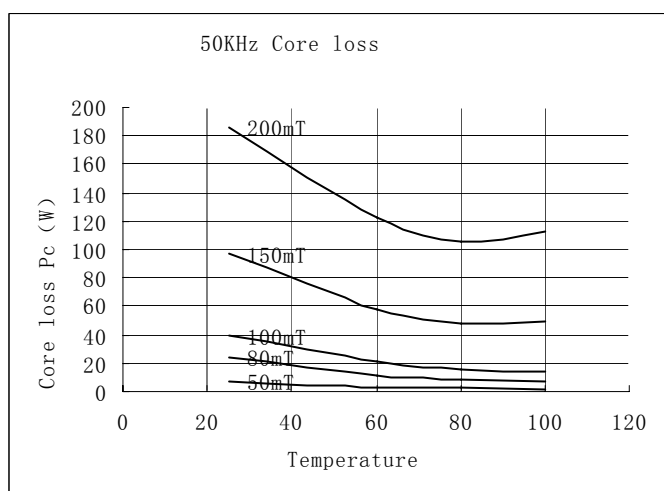

Circuit Type	Calculated Output Power				Unit W
	Switching Frequency				
	20KHz	50KHz	100KHz	250KHz	
Push-pull converter	73300	119200	165000	320900	
Flyback converter	24400	39700	55000	106900	
Forward converter	36600	59600	82500	160400	

# EE210

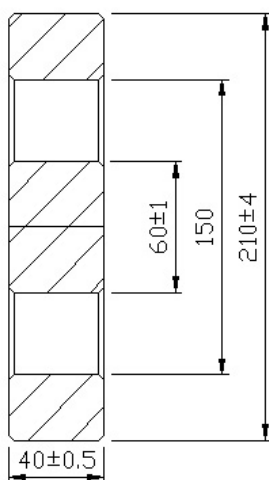
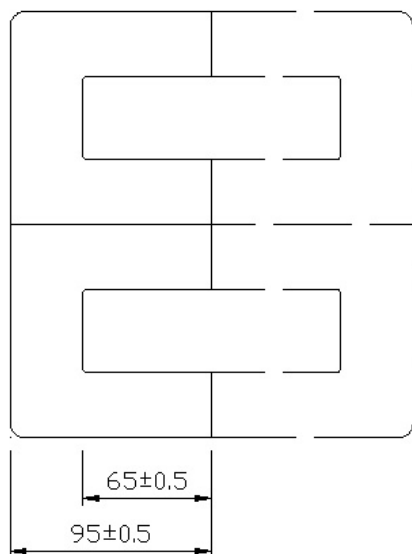

Parameter	Symbol	Value	Unit
Core constant	C1	0.183	mm <sup>-1</sup>
Effective path length	Le	440	mm
Effective area	Ae	2400	mm <sup>2</sup>
Effective volume	Ve	1128000	mm <sup>3</sup>
Inductance factor	AL	13750	nH/N <sup>2</sup>
Weight of set	W	5400	g

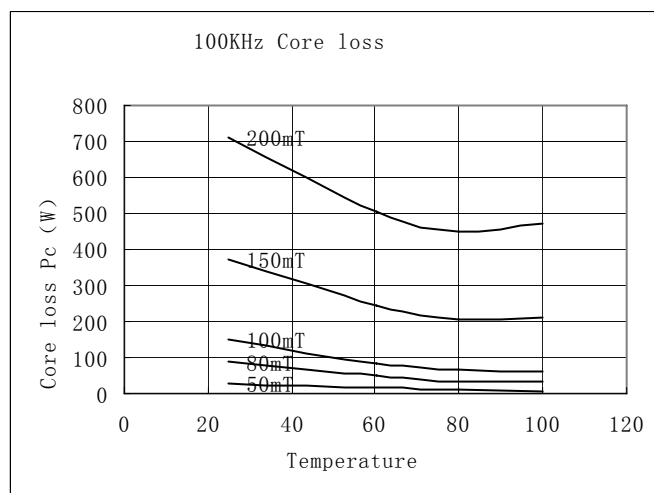
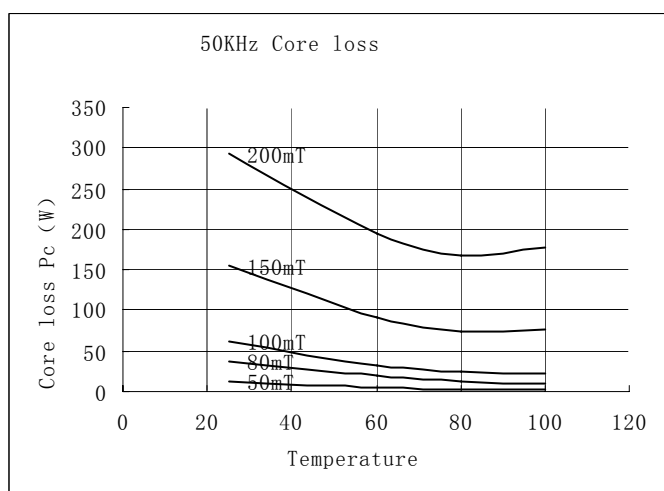

Circuit Type	Calculated Output Power				Unit W
	Switching Frequency				
	20KHz	50KHz	100KHz	250KHz	
Push-pull converter	90900	147700	204500	397700	
Flyback converter	30300	49200	68100	132500	
Forward converter	45400	73800	102200	198800	

# EE230

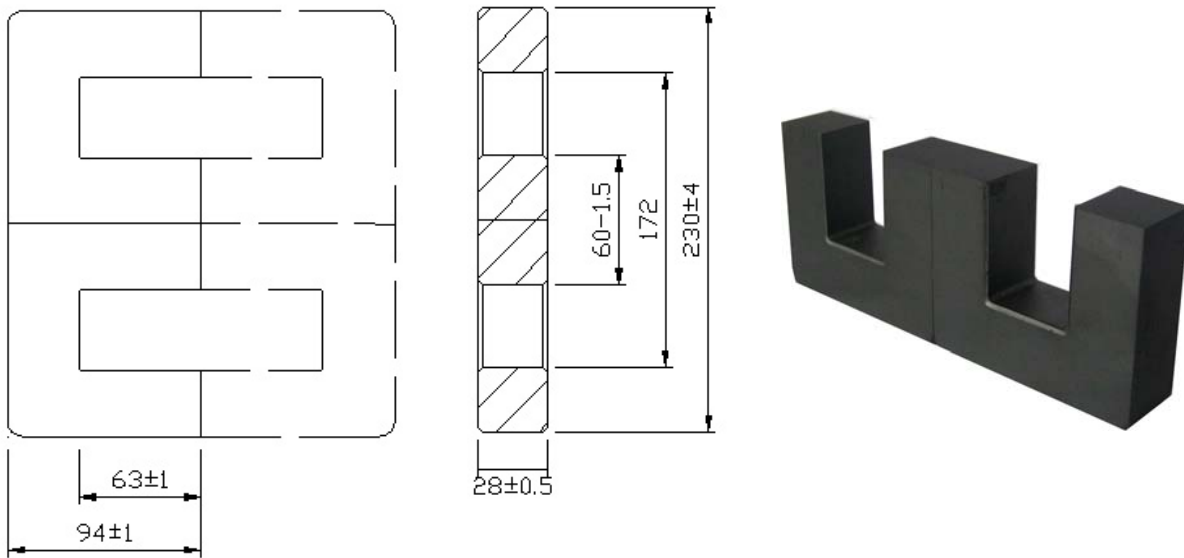

Parameter	Symbol	Value	Unit
Core constant	C1	0.27	mm <sup>-1</sup>
Effective path length	Le	454	mm
Effective area	Ae	1680	mm <sup>2</sup>
Effective volume	Ve	815584	mm <sup>3</sup>
Inductance factor	AL	9500	nH/N <sup>2</sup>
Weight of set	W	3900	g

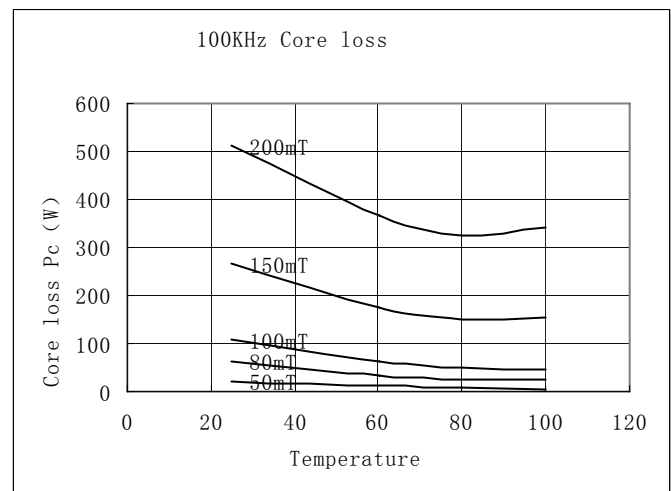
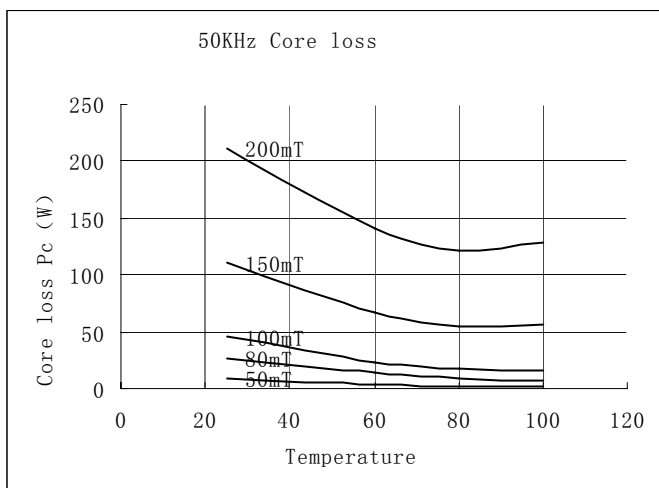

Circuit Type	Calculated Output Power				Unit W
	Switching Frequency				
	20KHz	50KHz	100KHz	250KHz	
Push-pull converter	76700	124700	172700	335800	
Flyback converter	25500	41500	57500	111900	
Forward converter	38300	62300	86300	167900	

# EE240

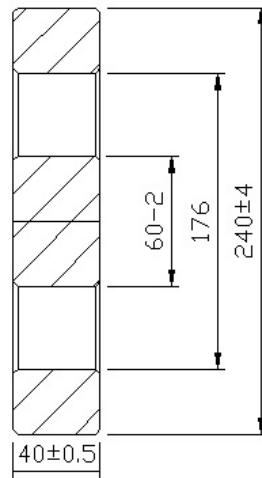
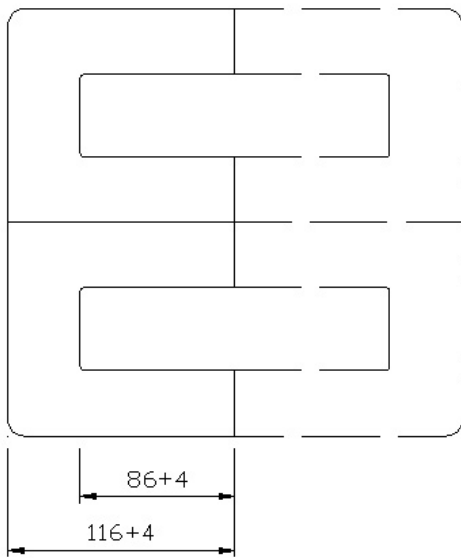

Parameter	Symbol	Value	Unit
Core constant	C1	0.229	mm <sup>-1</sup>
Effective path length	Le	550	mm
Effective area	Ae	2400	mm <sup>2</sup>
Effective volume	Ve	1429120	mm <sup>3</sup>
Inductance factor	AL	11300	nH/N <sup>2</sup>
Weight of set	W	6850	g

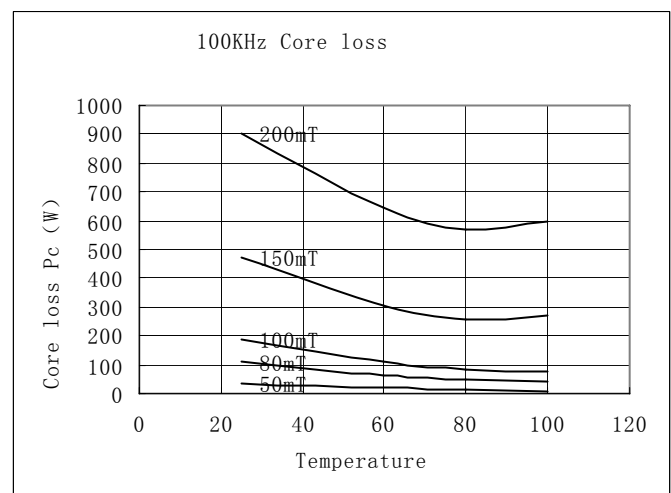
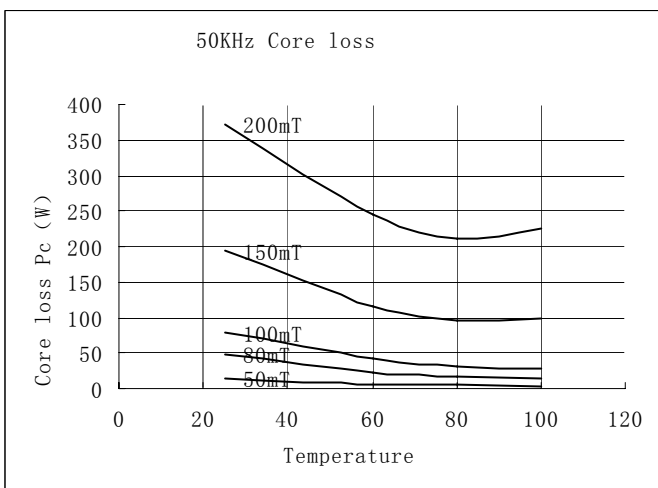

Circuit Type	Calculated Output Power				Unit W
	Switching Frequency				
	20KHz	50KHz	100KHz	250KHz	
Push-pull converter	155000	251900	348900	678200	
Flyback converter	51600	83900	116300	226000	
Forward converter	77500	125900	174400	339100	

# EE250

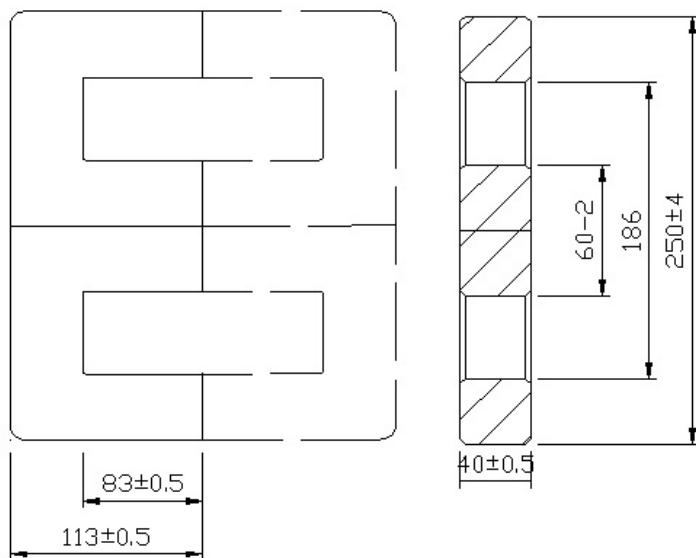

Parameter	Symbol	Value	Unit
Core constant	C1	0.228	$\text{mm}^{-1}$
Effective path length	Le	548	mm
Effective area	Ae	2400	$\text{mm}^2$
Effective volume	Ve	1423360	$\text{mm}^3$
Inductance factor	AL	11300	$\text{nH/N}^2$
Weight of set	W	6830	g

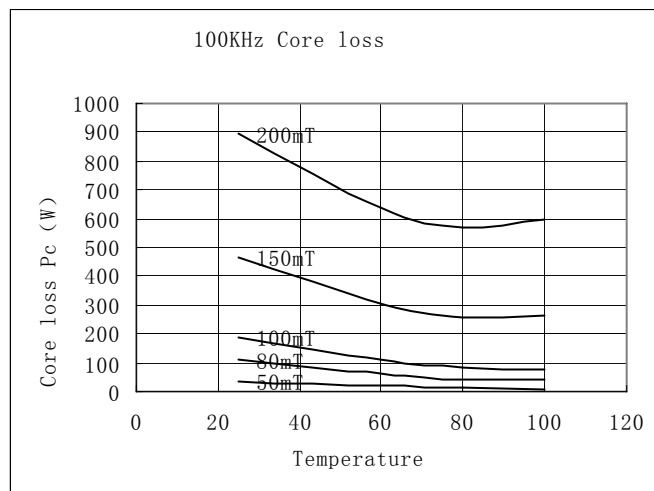
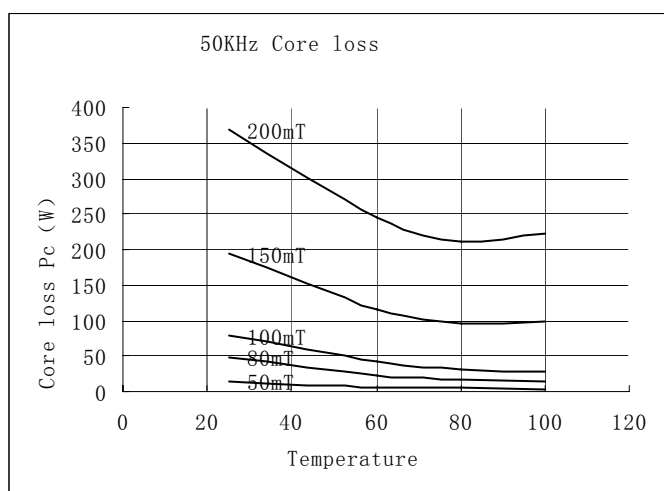

Circuit Type	Calculated Output Power				Unit W
	Switching Frequency				
	20KHz	50KHz	100KHz	250KHz	
Push-pull converter	162500	264100	365700	711000	
Flyback converter	54100	88000	121900	237000	
Forward converter	81200	132000	182800	355500	

# EE260

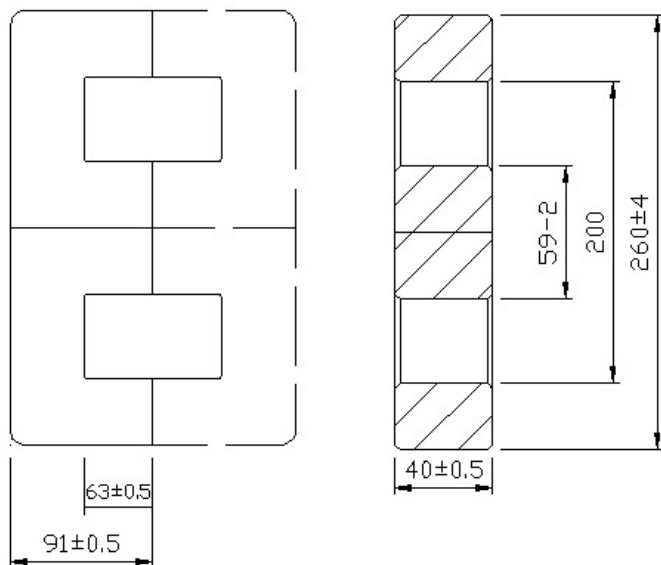

Parameter	Symbol	Value	Unit
Core constant	C1	0.204	mm <sup>-1</sup>
Effective path length	Le	481	mm
Effective area	Ae	2360	mm <sup>2</sup>
Effective volume	Ve	1182160	mm <sup>3</sup>
Inductance factor	AL	12300	nH/N <sup>2</sup>
Weight of set	W	5670	g

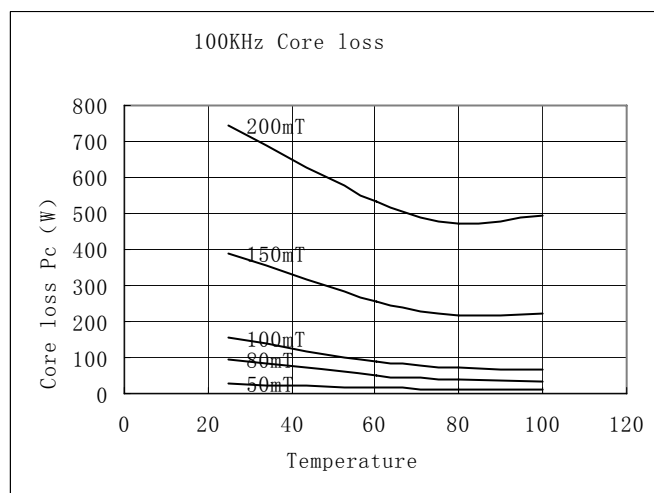
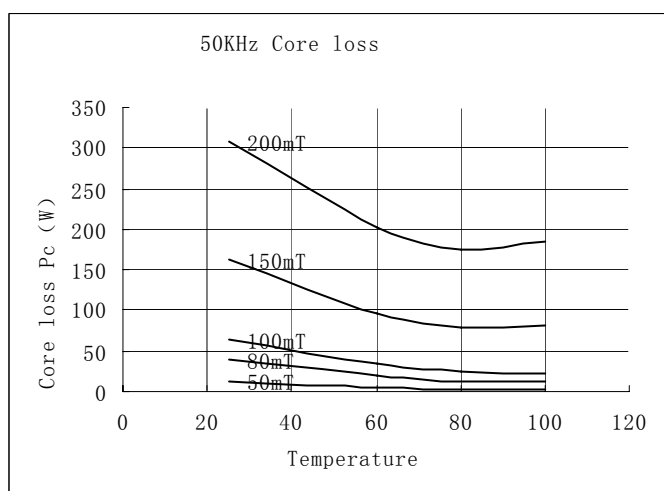

Circuit Type	Calculated Output Power				Unit W
	Switching Frequency				
	20KHz	50KHz	100KHz	250KHz	
Push-pull converter	135700	220600	305400	593800	
Flyback converter	45200	73500	101800	197900	
Forward converter	67800	110300	152700	296900	

# EE284

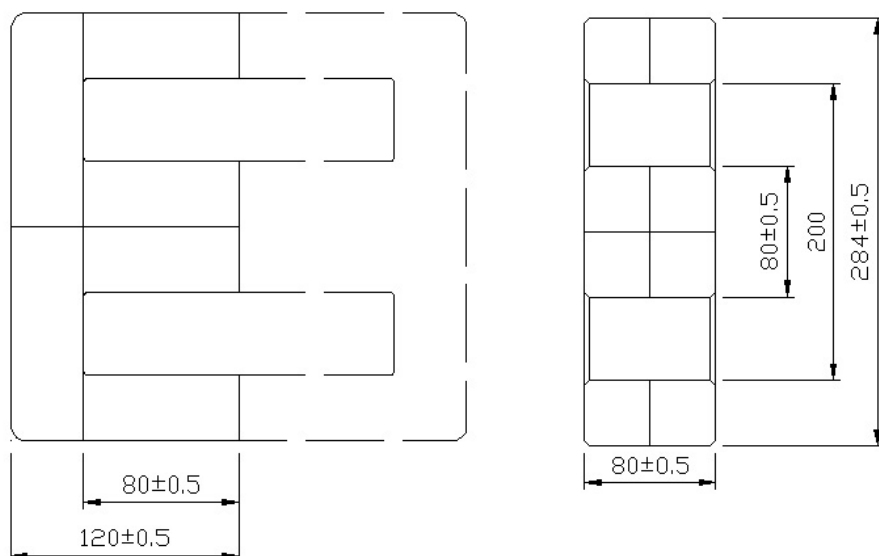

Parameter	Symbol	Value	Unit
Core constant	C1	0.087	mm <sup>-1</sup>
Effective path length	Le	560	mm
Effective area	Ae	6400	mm <sup>2</sup>
Effective volume	Ve	3916800	mm <sup>3</sup>
Inductance factor	AL	22500	nH/N <sup>2</sup>
Weight of set	W	18000	g

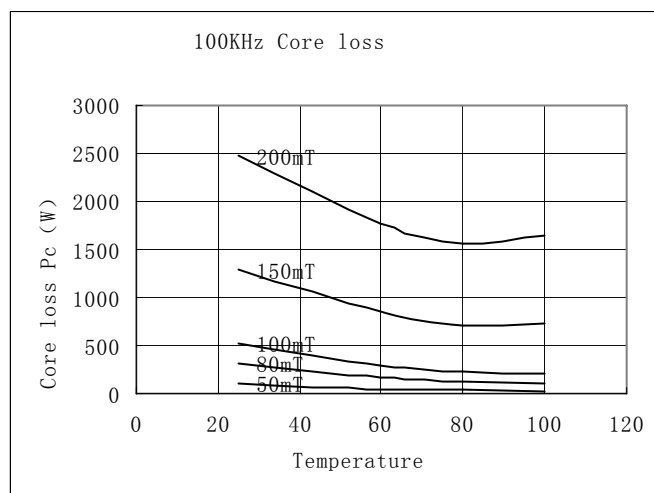
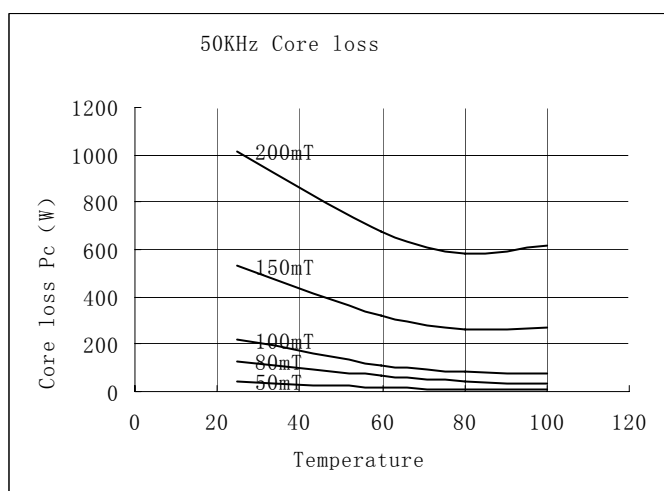

Circuit Type	Calculated Output Power				Unit W
	Switching Frequency				
	20KHz	50KHz	100KHz	250KHz	
Push-pull converter	397900	646600	895300	1740500	
Flyback converter	132600	215500	298400	580100	
Forward converter	198900	323300	447600	870200	



# EE320

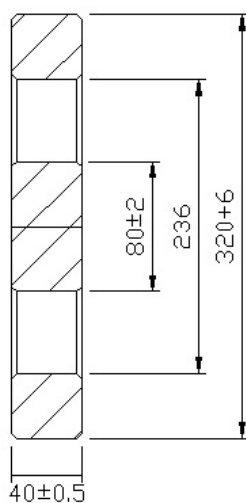
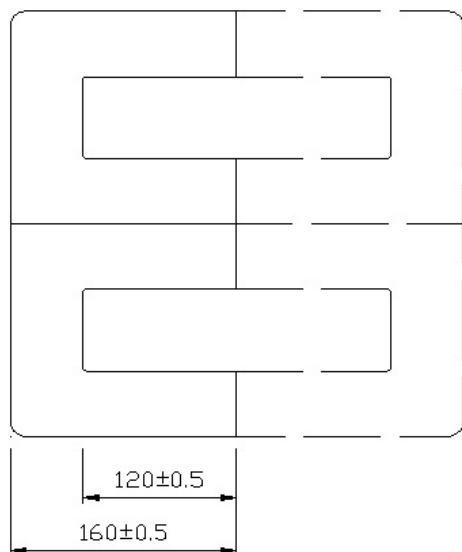

Parameter	Symbol	Value	Unit
Core constant	C1	0.236	mm <sup>-1</sup>
Effective path length	Le	756	mm
Effective area	Ae	3200	mm <sup>2</sup>
Effective volume	Ve	2598400	mm <sup>3</sup>
Inductance factor	AL	11000	nH/N <sup>2</sup>
Weight of set	W	12400	g

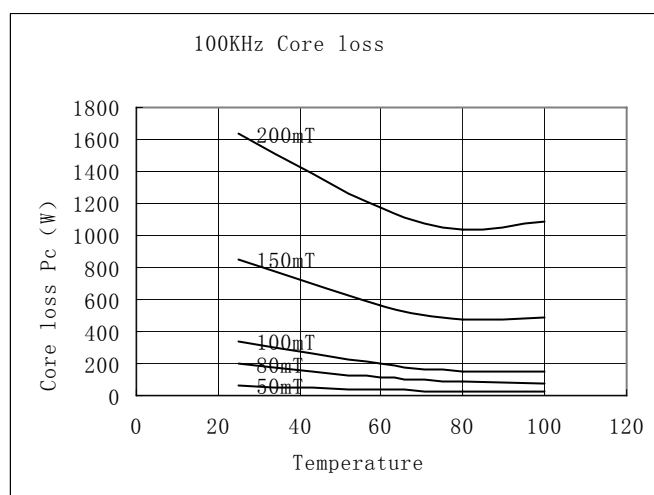
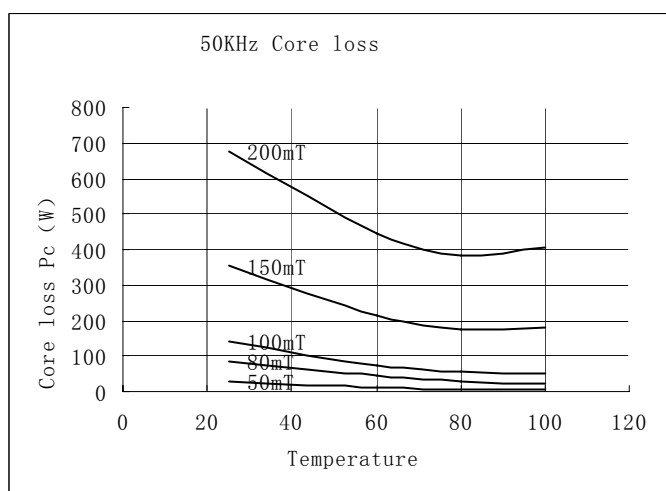

Circuit Type	Calculated Output Power				Unit W
	Switching Frequency				
	20KHz	50KHz	100KHz	250KHz	
Push-pull converter	387900	630400	872900	1697000	
Flyback converter	129300	210100	290900	565600	
Forward converter	193900	315200	436400	848500	

# EE480B

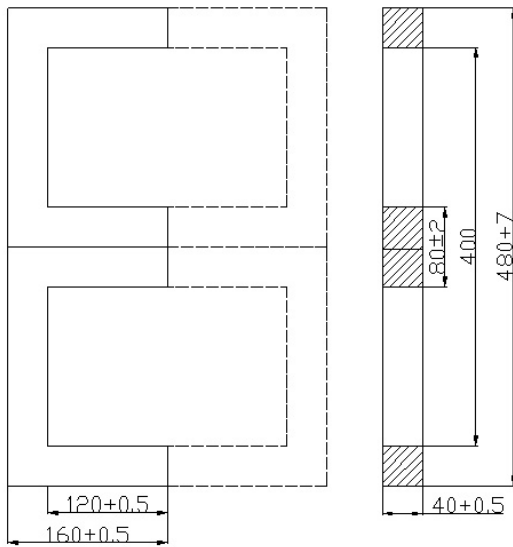

Parameter	Symbol	Value	Unit
Core constant	C1	0.2875	mm <sup>-1</sup>
Effective path length	Le	920	mm
Effective area	Ae	3200	mm <sup>2</sup>
Effective volume	Ve	3072000	mm <sup>3</sup>
Inductance factor	AL	8750	nH/N <sup>2</sup>
Weight of set	W	14700	g

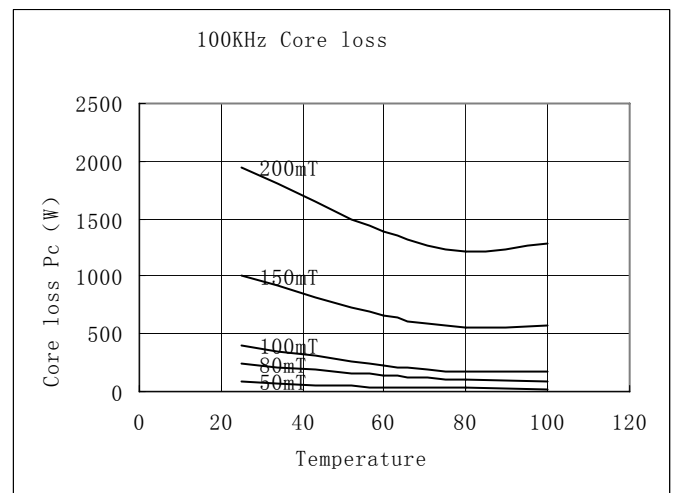
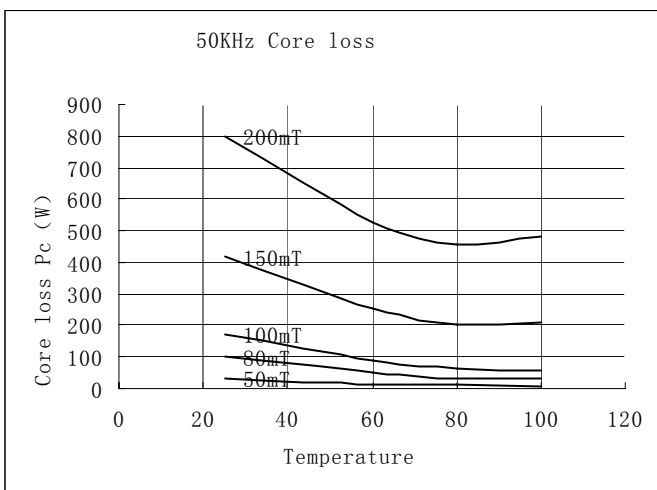

Circuit Type	Calculated Output Power				Unit W
	Switching Frequency				
	20KHz	50KHz	100KHz	250KHz	
Push-pull converter	795800	1293200	1790600	3481000	
Flyback converter	265200	431000	596800	1160300	
Forward converter	397900	646600	895300	174000	

# EE640

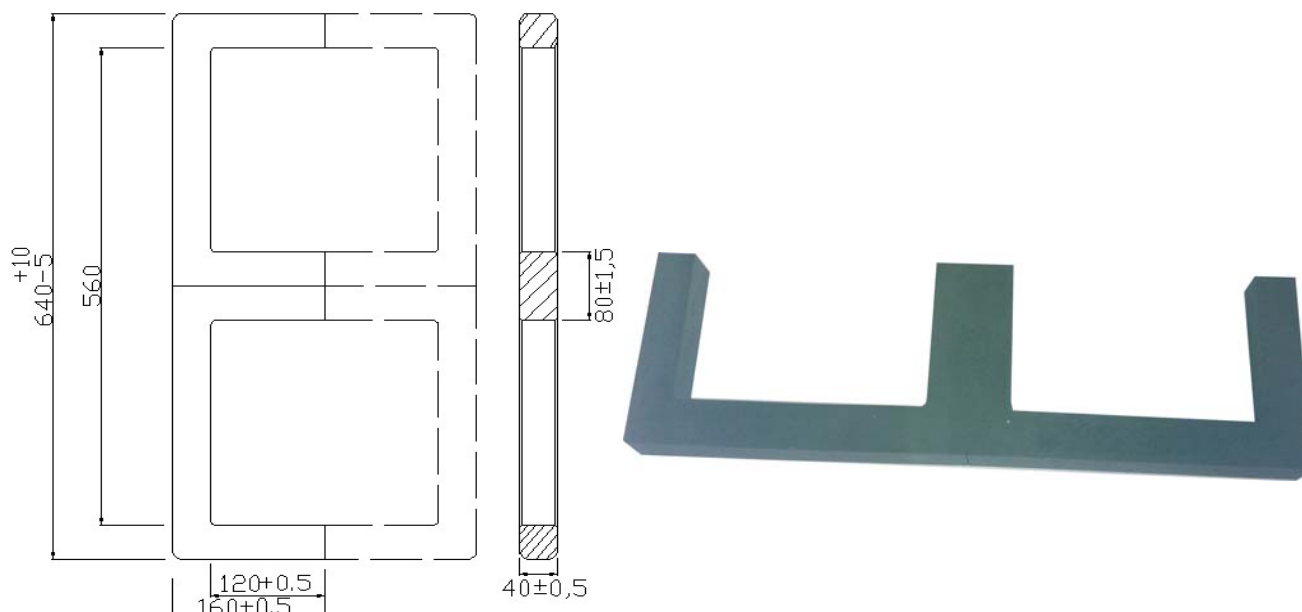

Parameter	Symbol	Value	Unit
Core constant	C1	0.33	mm <sup>-1</sup>
Effective path length	Le	1080	mm
Effective area	Ae	3200	mm <sup>2</sup>
Effective volume	Ve	3584000	mm <sup>3</sup>
Inductance factor	AL	8595	nH/N <sup>2</sup>
Weight of set	W	17203	g

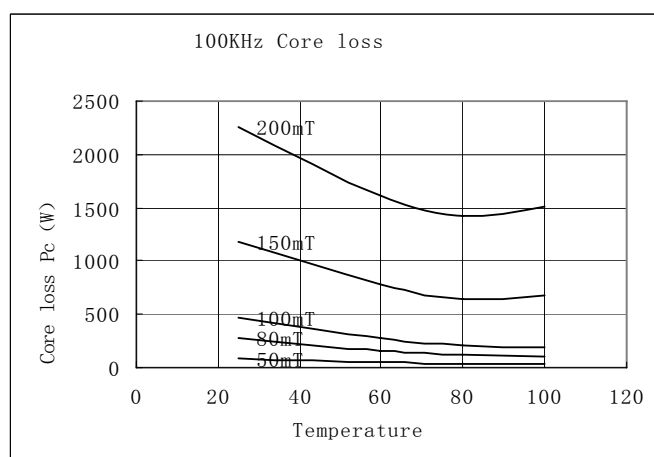
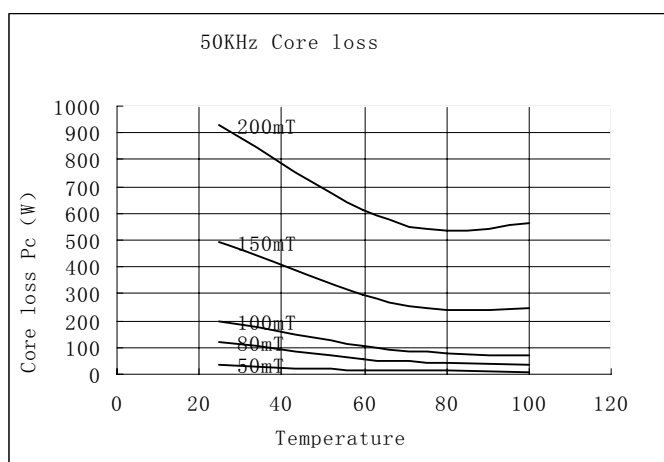

Circuit Type	Calculated Output Power				Unit W
	Switching Frequency				
	20KHz	50KHz	100KHz	250KHz	
Push-pull converter	1193800	1939900	2686000	5221600	
Flyback converter	397900	646600	895300	1740500	
Forward converter	596900	969900	1343000	2610800	